

# Instructions for A200 Size 2 Single Phase Motor Controller



I.L. 16957

Model J

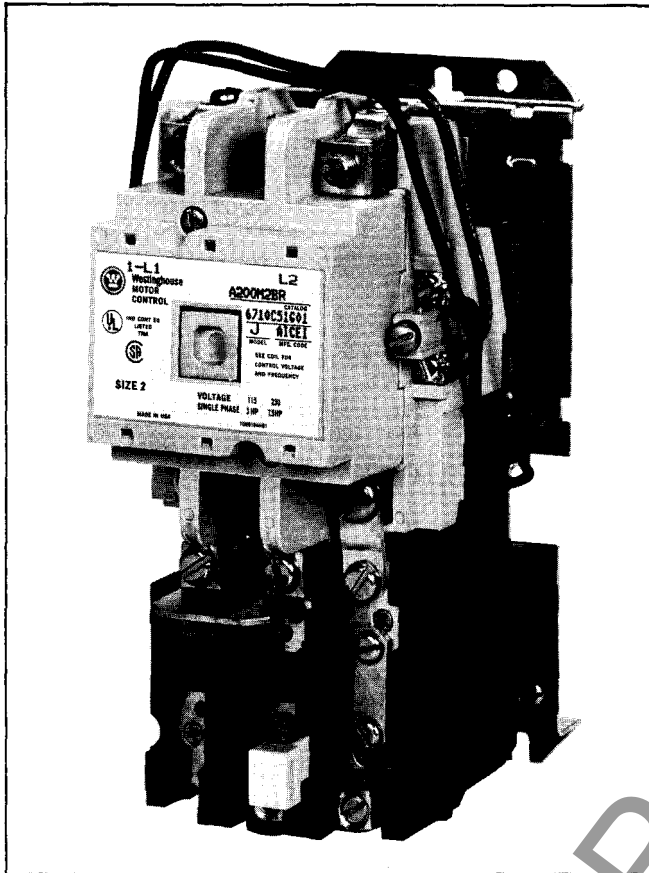

Fig. 1 Size 2 A200 Motor Controller

## THE CONTROLLER

The A200 motor controller, when wired as shown in Figure 5, will operate as a full voltage starter and will give protection against overload, but not against short circuit currents, when wired and provided with overload relay (OLR) heaters as listed in heater selection tables or when used with any means of inherent protection activated by motor temperature.

The controller should be protected against short circuits by providing branch circuit protection not to exceed the maximum protective device ratings listed in Table I.

CONTROLLER RATINGS			
NEMA SIZE	SINGLE PHASE HORSEPOWER AT 60 HERTZ		
	115 V	230V	
2	3	7½	

This industrial type control is designed to be installed, operated, and maintained by adequately trained workmen. These instructions do not cover all details, variations, or combinations of the equipment, its storage, delivery, installation, check out, safe operation, or maintenance. Care must be exercised to comply with local, state, and national regulations, as well as safety practices, for this class of equipment.

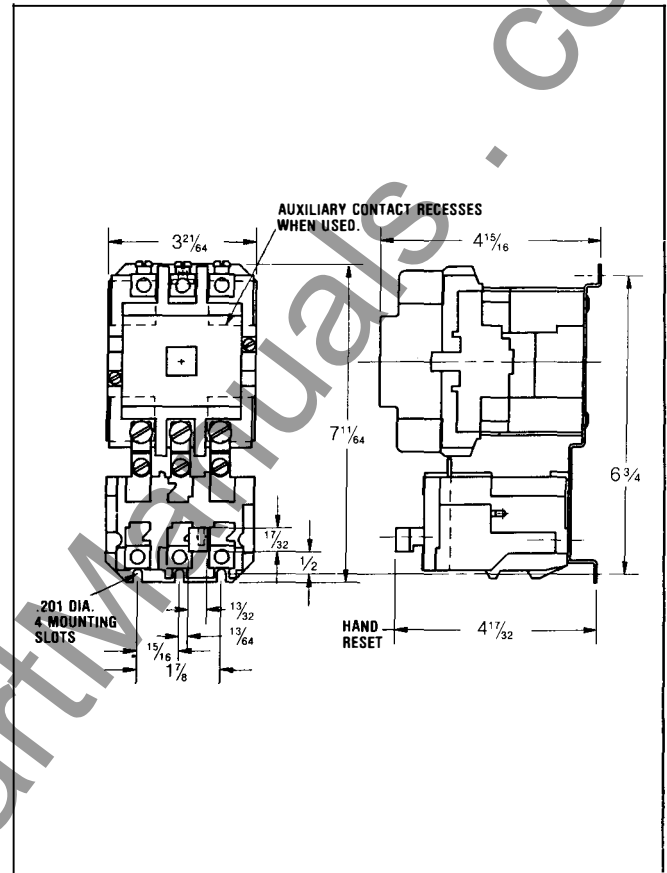

Fig. 2 Dimension Drawing (Dim. in inches)

TYPE B RELAY MAX. DIM. TO RESET  $A = 4 \frac{17}{32}$

## AUXILIARY CONTACTS — L56 (RATED B600)

An L56D with one normally open pole is supplied as the holding circuit auxiliary and is mounted in the upper left hand corner recess of the contactor. A maximum of four auxiliary units can be installed in the recesses of each contactor. These may be mounted with the terminals in line with the power poles or may be mounted with the terminals in a right angle relationship to the power poles. They mount by means of a spring clip which snaps into locations provided in the motor controller unit. To remove the L56 disengage the top spring clip, by pressing on the extended tab, and withdraw the unit.

L56 AUXILIARY CONTACTS		
Contact Type	Catalog No.	
1 Normally Closed	L56E	
1 Normally Open	L56D	
2 Normally Closed	L56C	
2 Normally Open	L56B	
1 Normally Open and 1 Normally Closed	L56	
L56 CONTACT RATINGS (B600)		
AC Volts	Make	Break
24-120	30A	3A
120-600	3600VA	360VA

**TYPE B OVERLOAD RELAY (See Figure 3)**

This A200 motor controller is usually equipped with a Type B block type ambient compensated overload relay (with gray reset rod). The controller can also be supplied with a non-ambient compensated overload relay (with red reset rod). The relay is of the bimetal actuated type equipped with a normally closed control contact. An optional isolated normally open control circuit is available for field mounting. When the overload relay trips, a yellow dot will appear flush with the molded surface below the reset rod. Resetting the relay returns this indicator to its normal concealed position.

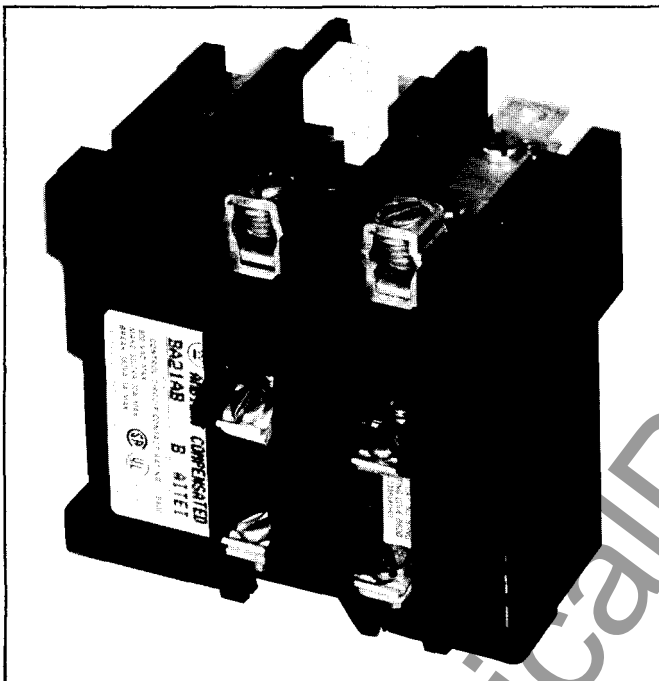

*Fig. 3 Type B Overload Relay*

**HEATERS**

Heaters are not included with the motor controller and must be ordered separately per the heater selection table and the information listed below. When installing heaters be sure that connecting surfaces are clean and heaters are attached securely to the relay in the proper location with the screws provided. The trip rating of a heater in a 40°C Ambient is 125% of the minimum full load current shown in Table I. When tested at 600 percent of its trip rating, the relay will trip in 20 seconds or less.

Heaters should be selected on the basis of the actual full load current and service factor as shown on the motor nameplate or in the manufacturer's published literature. When the service factor of the motor is 1.15 to 1.25, select heaters from

the heater application table. If the service factor of the motor is 1.0, or there is no service factor shown, or a maximum of 115% protection is desired, select one size smaller heater than indicated. When motor and overload relay are in different ambients and when using non-compensated overload relays, select heaters from the table using adjusted motor currents as follows: decrease rated motor current 1% for each °C motor ambient exceeds controller ambient. Increase rated motor current 1% for each °C controller ambient exceeds motor ambient.

<b>TABLE I — F SERIES HEATER SELECTION</b>			
For compensated OLR's in any size enclosure and non-compensated OLR's in enclosures with volume not less than 5500 cu. in. Wire with 75°C wire			
Code Marking	Full Load Current of Motor (Amperes) (40°C Ambient)	Max. Protect. Device Amp	Load Wire Size
FH46	17.3 — 18.9	60	#12
FH47	19.0 — 20.8	70	#10
FH48	20.9 — 22.9	70	#10
FH49	23.0 — 25.2	80	#10
FH50	25.3 — 27.6	90	#10
FH51	27.7 — 30.3	100	#8
FH52	30.4 — 33.3	100	#8
FH53	33.4 — 36.4	125	#8
FH54	36.5 — 39.9	125	#8
FH55	40.0 — 43.9	150	#6

Above Heaters for use on Size 2

**WARNING:** To provide continued protection against fire and shock hazard, the complete overload relay must be replaced if burnout of a current element occurs. See Table II.

<b>TYPE B OVERLOAD RELAY CONTROL CONTACT RATINGS (B600)</b>				
AC Volts	Normally Closed		Normally Open	
	Make	Break	Make	Break
24-120	30A	3A	30A	3A
120-600	3600VA	360VA	3600VA	360VA

**COIL**

The A200 motor controller is available with a single or dual voltage coil. When equipped with a single voltage coil, the contactor is wired as shown in Figure 5. A connection diagram for a dual voltage coil is shown in Figure 4. When supplied with a dual voltage coil, the motor controller is normally wired for the high voltage connection. The wiring may be changed to the low voltage connection by removing and reconnecting the jumpers as illustrated in Figure 4.

# A200 SIZE 2, SINGLE PHASE MOTOR CONTROLLER

I.L. 16957

## AC COIL DATA, SIZE 2 (TYPICAL VALUES)

Inrush VA	Sealed VA	Sealed Watts	Pickup (Time in Milliseconds)	Dropout
160	25	7.8	14-32	12-16

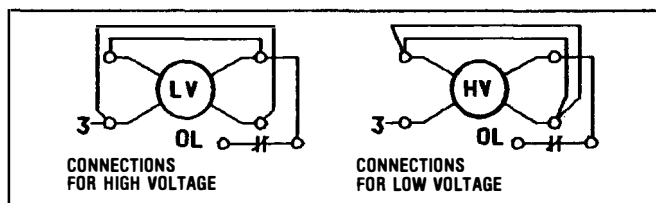

Fig. 4 Dual Voltage Coil Connections

## REPLACEMENT COIL: ORDER BY PART NUMBER, VOLTAGE, AND FREQUENCY

### SIZE 2 AC OPERATING COILS

Voltage	Freq.	Part Number
24	60	505C806G16
120/110	60/50	505C806G01
280	60	505C806G02
240	60	505C806G12
277	60	505C806G18
380	50	505C806G07
480/440	60/50	505C806G13
600	60	505C806G05
120/240*	60/60	505C806G10
240/480*	60/60	505C806G03

\* Dual Voltage Coils. Use only on starters originally supplied with a dual voltage coil.

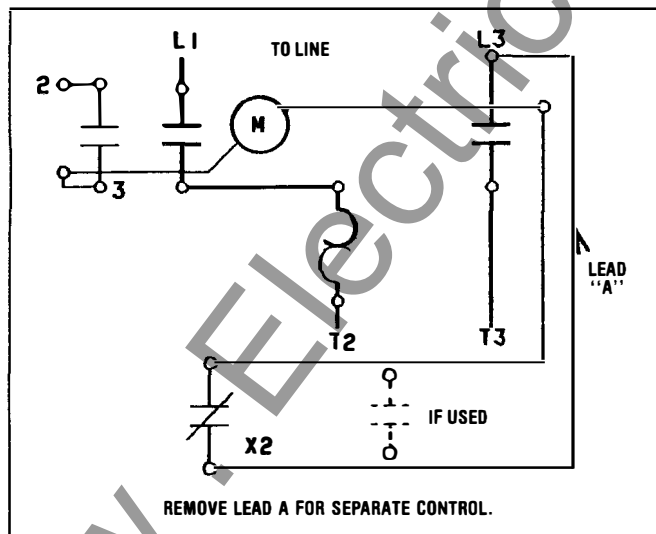

Fig. 5 Connection Diagram

## POWER CIRCUIT TERMINALS

NEMA Size	Wire Size
2	#12 - 3 AWG

Wire with copper conductors only.

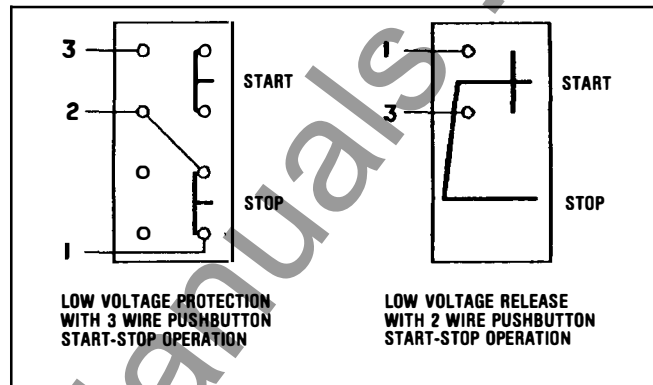

Fig. 6 Control Station Connection Diagram

## TABLE II — REPLACEMENT OVERLOAD RELAY

	CATALOG NUMBER SIZE 2
Type B Non-ambient Compensated	BN21A
Type B Ambient Compensated	BA21A

## TABLE III — ACCESSORIES

Alarm Circuit Contact for Type B Overload Relay Rated B600 (1 normally open pole) **Cat. No. B3NO-2**

Fuse Block Kits — Meet requirements of NEC concerning common control fusing.

Cat. No.	Qty.	Description
F56	2	Contact mounted Fuse Holder for 1 600 volt Bussman KTK Fuse
FKR	1	Panel mounted Fuse Holder for 2 Class CC (Bussman KTKR) Fuses*

\*Use when available fault current exceeds 10,000 amperes

Order Fuses Separately By Ampere Rating.

Controller Size	Minimum Wire Size in Control Circuit	Suggested Fuse Size†
2	#16 AWG	10 AMP

†When using a control transformer, select fuse size per the National Electrical Code.

## TABLE IV — RENEWAL PARTS

Pole Combination and Size	Contact Kit Part Number
2 Pole Size 2	373B331G11

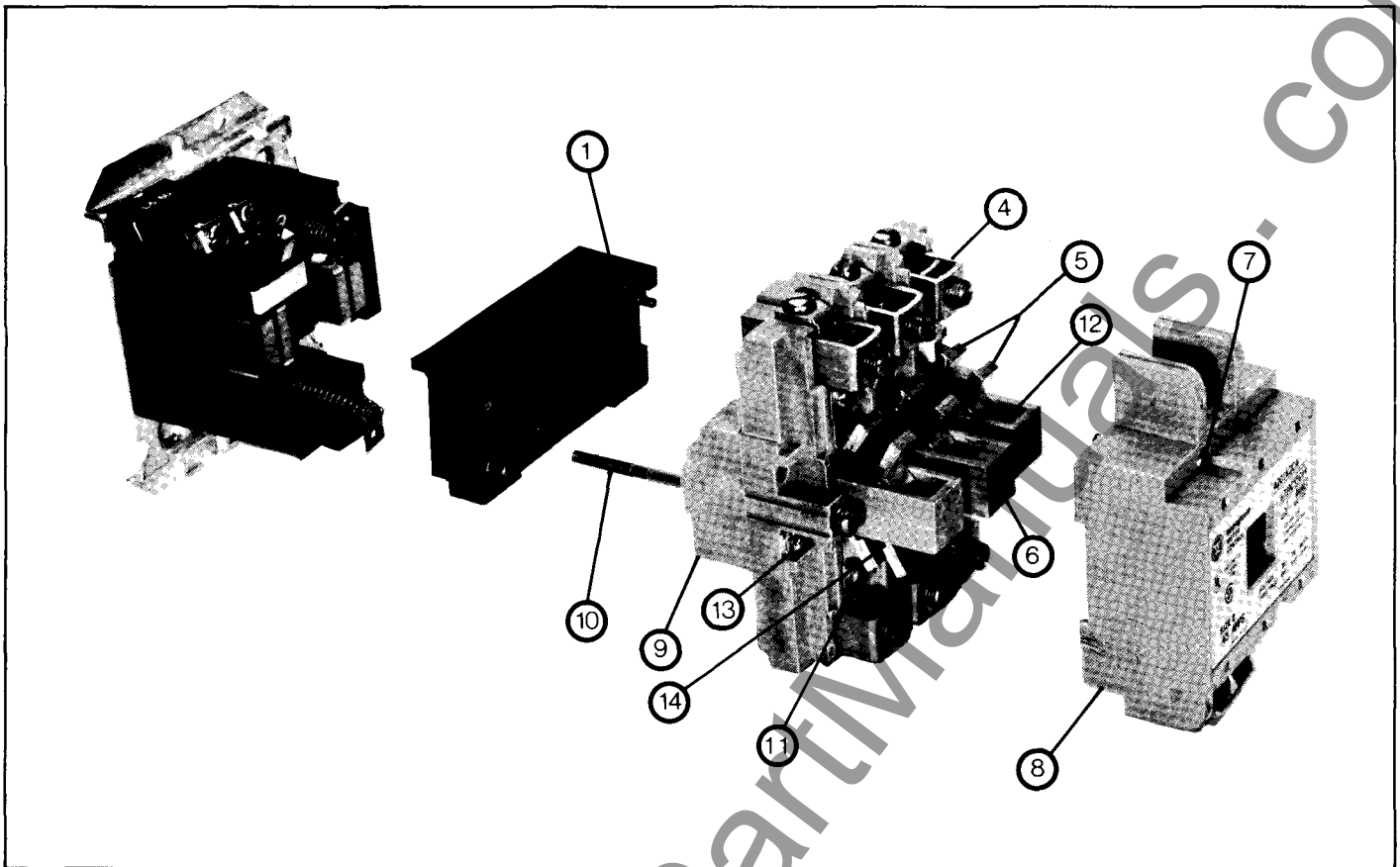

Fig. 7 Size 2 A200 Contactor (Exploded View)

**MAINTENANCE — First Turn Off Power —**

**To Inspect Contacts**

Refer to Figure 7. Loosen the two arc box assembly screws (7) located immediately above and below the nameplate and remove the arc box (8). Contacts (5) are visible. Retighten the screws per Table V.

**To Replace Contacts**

After removing the arc box and with replacement contacts at hand, compress the overtravel spring (12) and remove the moving contact (5) from the crossbar (6). Remove the retaining screws (11) and lift out the stationary contact carriers (14).

To replace contacts, reverse the above procedure, making sure that stationary contacts are free to move, overtravel springs are seated and the crossbar moves freely when the arc box is in position.

The silver cadmium oxide contact buttons need **NO** dressing or lubricant throughout their life.

**Important** — Replace all contacts and springs as a group to avoid misalignment.

**To Replace The Coil**

Refer to Figure 7. Loosen the assembly screws

(10) located to the immediate left and right of the arc box. Remove connector straps to the overload relay. Pull the loosened upper base structure (9) forward. Pull the coil (1) from the upper base, plug in a new coil, replace the upper base structure and check the auxiliary contacts for secureness when repositioning the upper base. Tighten the assembly screws and the connector straps screws referring to Table V.

**Magnet — Armature Assembly**

Self alignment and permanent air gap features of the magnet armature make replacement unnecessary. Mating pole face surfaces should be kept clean.

**Arc box must be in place when the controller interrupts a circuit.**

TABLE V — RECOMMENDED DRIVING TORQUE		
Location (Qty.)	Torque (lb.-in.)	Fig. 7 Item
Cover Screw (2)	9—12	7
Coil Wire Connector (2)	9—12	13
Stationary Contact Screw (4)	14—16	11
Main Power Connector (4)	40—50	4
Overload Relay Connecting Screws (3)	16—18	—
Overload Heater Fastening Screws (2)	16—18	—