



d-c magnetic contactors type MM—100 and 150 ampere

frame 301, 310, 311, 320, 321, 322,
401, 410, 411, 420, 421, 422

renewal
parts data

15-801B1

page 1

one pole kit of normal wearing parts

A one pole kit of normal wearing parts, style number 1620 043, consisting of one moving contact, one stationary contact and one contact spring has been packaged in a single carton. It is more economical to purchase these parts in this convenient, easily identified spare parts kit.

ordering information

- Name the part and give its style number.
- Give the complete nameplate reading.
- State method of shipment desired.
- Send all orders or correspondence to nearest sales office of the company.

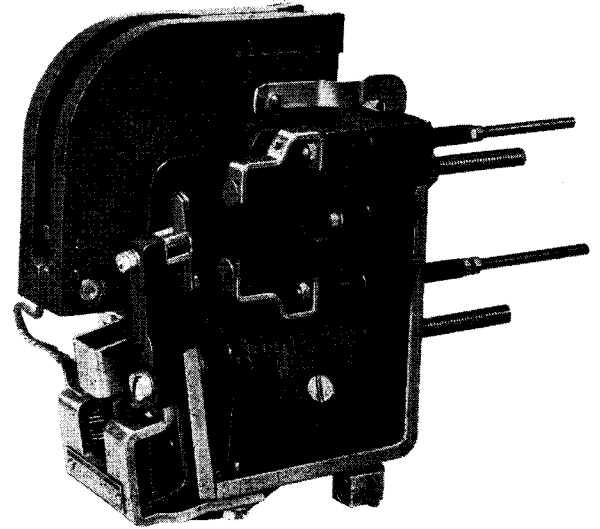

operating coils

voltage	style number	
	frames 301-401 310-410 320-420	frames 311-321-322-411-421-422 upper coil lower coil
65	1490 640	1600 767
115	1490 640	1490 640 1622 906
125	1600 763	1600 763
230	1490 641	1490 641 1622 907
250	1626 810	1626 810 30B4376G17
550	1622 924	1622 924 1622 908

contactor with coil

style number				style number			
complete contactor	contactor less coil	upper coil	lower coil	complete contactor	contactor less coil	upper coil	lower coil
1745 004	1502 676	1490 641	31D9652G02	1502 677	1626 810
1745 005	1502 682	1490 641	31D9652G10	1502 683	1626 810
1745 006	1596 680	1490 641	31D9668G01	1502 684	1600 767
1745 007	1502 684	1490 641	1622 907	199A070G01	552D181G13	1490 641
1776 954	1502 684	1600 763	199A070G17	552D181G18	1600 763
1776 955	1502 684	1626 810	199A070G18	552D181G18	1600 767	1622 907
31D9649G03	552D181G02	1490 640	203A195G01	552D181G18	1626 810

contactor with coil and interlocks

style number				interlock	
complete contactor	contactor less coil	upper coil	lower coil	*	■
31D9649G01	552D181G02	1490 641	1399 072 (2)
31D9649G02	552D181G02	1626 810	1399 072 (2)
31D9649G09	552D181G14	1490 641	1399 072 (1) 1399 073 (1)
31D9649G10	552D181G14	1626 810	1399 072 (1) 1399 073 (1)
31D9652G03	1502 677	1626 810	1399 072 (2)
31D9652G11	1502 683	1626 810	1399 072 (2)
31D9668G02	1502 684	1490 640	1320 792 (2)	1399 075 (2)
31D9668G03	1502 685	1600 767	1776 721 (2)	1399 073 (2)
31D9668G04	1502 685	1490 640	1776 721 (2)	1399 073 (2)
31D9668G05	1502 685	1490 641	1776 721 (2)	1399 073 (2)
199A070G02	552D181G13	1490 641	1399 074 (1) 1399 075 (1)
199A070G03	552D181G13	1490 641	1320 792 (1)	1399 074 (1)
199A070G04	552D181G13	1490 641	1399 074 (2)
199A070G09	552D181G01	1490 641	1399 074 (1)
203A195G17	552D181G21	1490 641	1622 907	1320 794 (1)	1399 072 (1)
203A195G18	552D181G21	1626 810	30B4376G17	1320 794 (1)	1399 072 (1)
203A195G25	552D181G09	1490 641	1622 907	1399 072 (2)
203A195G26	552D181G09	1626 810	30B4376G17	1399 072 (2)

* For interlock parts see RPD15-829A2
 ■ For interlock parts see RPD15-829A3
 () Figure in parenthesis indicates number used.

August, 1966

supersedes RPD 15-801B1 dated November, 1960
 mailed to: E, D, C/2752

ref. no.	description of part	type and frame of contactor								no. used
		MM-310	MM-311	MM-311	MM-320	MM-321	MM-321	MM-322	MM-301	
		front connected (contactor mechanical parts style number)								
		1502 677	1502 679	1502 681	1502 683,A	1502 685,A	1502 687,A	1502 689,A	1596 681	
		rear connected (contactor mechanical parts style number)								
		1502 676	1502 678	1502 680	1502 682,A	1502 684,A	1502 686,A	1502 688,A	1596 680	
		style number of parts								
1	armature complete.....	1625 891	1625 892	1625 892	1625 893	1625 894	1625 894	1625 895	1625 890	1
2	bare armature.....	1490 518	1490 519	1490 519	1257 432	1490 520	1490 520	1257 434	1490 520	1
3	moving contact finger.....	1490 515	1490 515	1490 515	1490 515	1490 515	1490 515	1490 515	1490 515	1
4	contact spring.....	1490 698	1490 698	1490 698	1490 698	1490 698	1490 698	1490 698	1490 698	1
5	shunt.....		1289 475	1289 475						1
6	shunt.....	1419 193			1490 696	1490 696	1490 696	1490 696		1
7	shunt.....				1490 697	1490 697	1490 697		1490 697	1
8	shunt.....		1490 697	1490 697					1256 528	1
9	shunt screw— $\frac{5}{16}$ " long.....				std. hdwr.	std. hdwr.	std. hdwr.	std. hdwr.		1
9	shunt screw— $\frac{1}{4}$ "-20x $\frac{1}{2}$ fil. hd. steel.....									1
9	shunt screw— $\frac{3}{8}$ " long.....	1355 076	1355 076	1355 076						1
10	contact finger support—right hand.....				1406 689	1406 689	1406 689	1406 689		1
11	contact finger support—left hand.....				1406 688	1406 688	1406 688	1406 688		1
12	spring holder.....				1308 184	1308 184	1308 184	1308 184		1
13	armature stop.....	1625 896	1625 898	1625 896					1625 899	1
14	armature stop.....				1625 897	1625 899	1625 897	1625 897	1625 899	1
15	frame with core.....				1257 424	1818 160	1818 160	1818 160		1
16	frame with core.....	1289 431	1818 159	1818 159					1344 148	1
17	frame with core.....								1289 047	1
18	frame with core—lower.....					1320 655				1
19	frame with core—lower.....		1320 655				1320 656			1
20	frame with core—lower.....			1320 656				1320 657		1
21	frame with core—lower.....									1
△	base assembly without contact—rear connected.....	1490 510	1490 510	1490 510	1502 673	1502 673	1502 673	1502 673	1490 510	1
△	base assembly without contact—front connected.....	1490 511	1490 512	1490 512	1502 674	1502 675	1502 675	1502 675	1490 511	1
△	base assembly without contact—lower—rear connected.....		1490 510	1490 506		1490 510	1490 506	1502 673		1
△	base assembly without contact—lower—front connected.....		1490 512	1257 394		1490 512	1257 394	1502 675		1
22 to 36	base assembly details.....	see table on page 3								
37	armature spring.....	1289 441	1289 441	1289 441	1289 442	1289 442	1289 442	1289 442	1596 679	1
38	stationary contact.....	1490 516	1490 516	1490 516	1490 516	1490 516	1490 516	1490 516	1490 516	1
△	contact screw.....	1355 076	1355 076	1355 076	1355 076	1355 076	1355 076	1355 076	1355 076	1
39	arc box.....	1490 517	1490 517	1490 517	1490 517	1490 517	1490 517	1490 517	1490 517	1
40	pole face—lower.....	1257 462	1257 462	1257 462	1257 462	1257 462	1257 462	1257 462	1257 462	1
41	pole face.....	1308 247	1308 247	1308 247	1308 247	1308 247	1308 247	1308 247	1308 247	1
42	steel coil washer.....	1486 999	1486 999	1486 999	1486 999	1486 999	1486 999	1486 999	1486 999	1
43	felt coil washer.....		1308 248	1308 248		1308 248	1308 248	1308 248		1
44	base insulation.....	1257 414	1257 414	1257 414		1257 414			1257 414	1
45	bent connector.....	1257 356	1257 356	1257 356		1257 356	1257 356		1257 356	1
46	flat connector.....				1308 329	1308 329	1308 329	1308 329		1
47	terminal.....	1367 770	1367 770	1367 770	1367 770	1367 770	1367 770	1367 770	1367 770	1
48	shunt stud.....	1490 504	1490 504	1490 504	1490 504	1490 504	1490 504	1490 504	1490 504	1
49	mounting stud.....	1823 914	1823 914	1823 914	1823 914	1823 914	1823 914	1823 914	1823 914	1
△	coil screw.....	1106 642	1106 642	1106 642	1106 642	1106 642	1106 642	1106 642	1106 642	1

parts indented are included in the part under which they are indented
 ■ see table below for number used △ not illustrated

ref. no.	description of part	contactor mechanical parts style number														
		1502 676	1502 677	1502 678	1502 679	1502 680	1502 681	1502 682	1502 683	1502 684	1502 685	1502 686	1502 687	1502 688	1502 689	1596 680
		number used														
3	moving contact finger.....	1	1	2	2	2	2	2	2	3	3	3	4	4	1	1
4	contact spring.....	1	1	2	2	2	2	2	2	2	2	2	4	4	1	1
7	shunt.....	-	-	-	-	-	-	-	-	-	-	-	-	-	-	-
9	shunt screw— $\frac{1}{2}$ " long.....	-	-	-	-	2	2	-	-	-	-	-	-	-	-	-
9	shunt screw— $\frac{3}{8}$ " long.....	1	1	2	2	-	-	-	-	-	-	-	-	-	-	-
10	contact finger support—right hand.....	-	-	-	-	-	-	1	1	1	1	1	2	2	-	-
11	contact finger support—left hand.....	-	-	-	-	-	-	2	2	2	2	2	4	4	-	-
12	spring holder.....	-	-	-	-	-	-	1	1	1	1	1	1	1	1	1
37	armature spring.....	2	2	2	2	2	2	2	2	3	3	3	4	4	1	1
38	stationary contact.....	1	1	2	2	2	2	2	2	3	3	3	4	4	1	1
△	contact screw.....	1	1	2	2	2	2	2	2	3	3	3	4	4	1	1
39	arc box.....	1	1	2	2	2	2	2	2	2	2	2	4	4	1	1
44	base insulation.....	2	2	4	4	2	2	-	-	-	-	-	-	-	-	-
45	bent connector.....	-	1	-	1	-	-	-	-	2	2	2	4	4	-	-
46	flat connector.....	-	-	-	-	-	-	-	-	1	1	2	-	-	-	-
47	terminal.....	-	2	-	3	-	-	-	4	-	6	-	6	-	8	-
48	shunt stud.....	1	1	2	2	2	2	2	2	2	2	2	2	2	1	1
49	mounting stud.....	1	1	2	2	2	2	2	2	2	2	2	2	2	1	1
△	coil screw.....	2	2	4	4	4	4	4	4	4	4	4	4	4	2	2

△ not illustrated

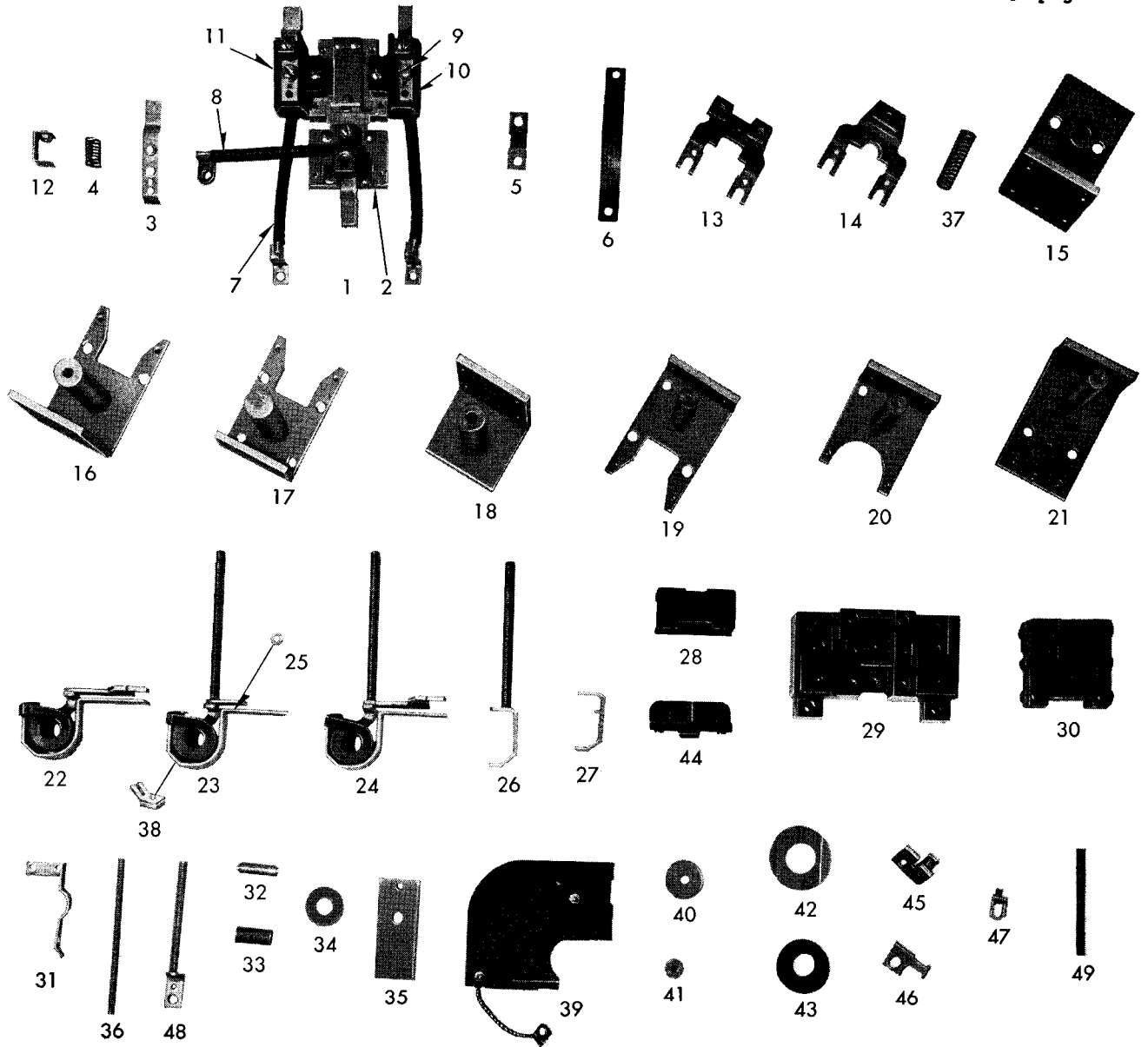

base assembly details

ref. no.	description of part	style number of part	stationary contact base style number							
			1257 394	1490 506	1490 510	1490 511	1490 512	1502 673	1502 674	1502 675
△	base assembly without contact.....	see pg 2								
22	blowout coil.....	1490 507	1	1	1	1	1	1	1	1
23	blowout coil.....	1490 508	-	-	-	-	-	-	-	-
24	blowout coil.....	1490 509	-	-	1	-	-	2	-	2
25	insulating washer.....	208A560H05	-	-	1	1	1	-	2	-
26	stationary contact support.....	1490 505	-	1	-	-	-	-	-	2
27	stationary contact support.....	1331 781	1	-	-	-	-	-	-	-
28	bare base.....	1257 350	-	-	-	-	-	-	-	-
29	bare base.....	1419 591	-	-	-	-	-	-	-	-
30	bare base.....	1419 592	-	-	1	1	1	1	1	1
28	bare base.....	1419 593	-	1	-	-	-	-	-	-
31	arc box clip.....	1419 590	-	-	1	1	1	2	2	2
32	blowout coil core.....	1257 371	-	-	1	1	1	2	2	2
33	insulating tube.....	1257 373	-	-	1	1	1	2	2	2
34	insulating washer.....	1257 374	-	-	2	2	2	4	4	4
35	pole piece—tapped.....	1257 366	-	-	1	1	1	2	2	2
35	pole piece—drilled.....	1257 367	-	-	1	1	1	2	2	2
△	pole piece screw—190-32 x 1½" flat head brass machine.....	std. hdwr.	-	-	1	1	1	2	2	2
36	shunt stud.....	392 454	-	-	-	-	-	2	2	2

parts indented are included in the part under which they are indented
△ not illustrated

ref. no.	description of part	type and frame of contactor								no. used
		MM-410	MM-411	MM-411	MM-420	MM-421	MM-421	MM-422	MM-401	
		front connected (contactor mechanical parts style number)								
		552D181G02	552D181G07	552D181G09	552D181G14	552D181G19	552D181G21	552D181G26	552D181G31	
		rear connected (contactor mechanical parts style number)								
		552D181G01	552D181G06	552D181G08	552D181G13	552D181G18	552D181G20	552D181G25	552D181G30	
		style number of parts								
1	armature complete	427 C696 G02	427 C696 G03	427 C696 G03	427 C696 G04	427 C696 G05	427 C696 G05	427 C696 G06	427 C696 G01	1
2	bare armature	1490 518	1490 519	1490 519	1257 432	1490 520	1490 520	1257 434	1490 520	1
3	moving contact finger	1490 515	1490 515	1490 515	1490 515	1490 515	1490 515	1490 515	1490 515	1
4	contact spring	1490 698	1490 698	1490 698	1490 698	1490 698	1490 698	1490 698	1490 698	1
5	shunt	1289 475	1289 475	1289 475						1
6	shunt	16B9647 G02			297B760 G01	297B760 G01	297B760 G01	297B760 G01	297B760 G01	1
7	shunt		297B681 G01	297B681 G01					297B681 G01	1
8	shunt					1256 528	1256 528		1256 528	1
9	shunt screw— $\frac{3}{16}$ " long				std. hdw.	std. hdw.	std. hdw.	std. hdw.		1
9	shunt screw— $\frac{1}{4}$ -20 x $\frac{1}{2}$ "									1
9	fillister head steel mach. screw									1
9	shunt screw— $\frac{3}{8}$ " long	1355 076	1355 076	1355 076						1
10	contact finger support—right hand				1406 689	1406 689	1406 689	1406 689		1
11	contact finger support—left hand				1406 688	1406 688	1406 688	1406 688		1
12	spring holder				1308 184	1308 184	1308 184	1308 184		1
13	armature stop	1625 896	1625 898	1625 896						1
14	armature stop				1625 897	1625 899	1625 897	1625 897	1625 899	1
15	frame with core				1257 424	1818 160	1818 160	1818 160		1
16	frame with core	1289 431	1818 159	1818 159					1344 148	1
17	frame with core								1289 047	1
18	frame with core—lower									1
19	frame with core—lower		1320 655			1320 655				1
20	frame with core—lower			1320 656				1320 656		1
21	frame with core—lower							1320 657		1
△	base assembly without contact—rear connected	1490 510	1490 510	1490 510	1502 673	1502 673	1502 673	1502 673	1490 510	1
△	base assembly without contact—front connected	1490 511	1490 512	1490 512	1502 674	1502 675	1502 675	1502 675	1490 511	1
△	base assembly without contact—lower—rear connected		1490 510	1490 506		1490 510	1490 506	1502 673		1
△	base assembly without contact—lower—front connected		1490 512	1257 394		1490 512	1257 394	1502 675		1
22 to 36	base assembly details	see table on page 3								
37	armature spring	1289 441	1289 441	1289 441	1289 442	1289 442	1289 442	1289 442	1596 679	1
38	stationary contact	1490 516	1490 516	1490 516	1490 516	1490 516	1490 516	1490 516	1490 516	1
△	contact screw	1355 076	1355 076	1355 076	1355 076	1355 076	1355 076	1355 076	1355 076	1
39	arc box	1490 517	1490 517	1490 517	1490 517	1490 517	1490 517	1490 517	1490 517	1
40	pole face	1257 462	1257 462	1257 462	1257 462	1257 462	1257 462	1257 462	1257 462	1
41	pole face—lower	1308 247	1308 247	1308 247	1308 247	1308 247	1308 247	1308 247	1308 247	1
42	steel coil washer	1486 999	1486 999	1486 999	1486 999	1486 999	1486 999	1486 999	1486 999	1
43	felt coil washer		1308 248			1308 248		1308 248		1
44	base insulation	1257 414	1257 414	1257 414		1257 414			1257 414	1
45	bent connector	1257 356	1257 356	1257 356		1257 356		1257 356	1257 356	1
46	flat connector				1308 329	1308 329	1308 329	1308 329		1
47	terminal	13B5866 G02	13B5866 G02	13B5866 G02	13B5866 G02	13B5866 G02	13B5866 G02	13B5866 G02	13B5866 G02	1
48	shunt stud	1490 504	1490 504	1490 504	1823 914	1823 914	1823 914	1823 914	1823 914	1
49	mounting stud	1823 914	1823 914	1823 914	1823 914	1823 914	1823 914	1823 914	1823 914	1
△	coil screw	1106 642	1106 642	1106 642	1106 642	1106 642	1106 642	1106 642	1106 642	1

Parts indented are included in the part under which they are indented.
△ not illustrated ■ see table below for number used.

ref. no.	description of part	contactor mechanical parts style number															
		552D181G01	552D181G02	552D181G06	552D181G07	552D181G08	552D181G09	552D181G13	552D181G14	552D181G18	552D181G19	552D181G20	552D181G21	552D181G25	552D181G26	552D181G30	552D181G31
3	moving contact finger	1	1	2	2	2	2	2	2	3	3	3	3	4	4	1	1
4	contact spring	1	1	2	2	2	2	2	2	3	3	3	3	4	4	1	1
7	shunt	1	1	2	2	2	2	2	2	2	2	2	2	4	4	1	1
9	shunt screw— $\frac{1}{2}$ " long	1	1	2	2	2	2	2	2	2	2	2	2	4	4	1	1
9	shunt screw— $\frac{3}{8}$ " long	1	1	2	2	2	2	2	2	2	2	2	2	4	4	1	1
10	contact finger support—right hand	1	1	2	2	2	2	2	2	1	1	1	1	2	2	1	1
11	contact finger support—left hand	1	1	2	2	2	2	2	2	1	1	1	1	2	2	1	1
12	spring holder	2	2	2	2	2	2	2	2	1	1	1	1	4	4	1	1
37	armature spring	1	1	2	2	2	2	2	2	3	3	3	3	4	4	1	1
38	stationary contact	1	1	2	2	2	2	2	2	3	3	3	3	4	4	1	1
△	contact screw	1	1	2	2	2	2	2	2	2	2	2	2	4	4	1	1
39	arc box	1	1	2	2	2	2	2	2	2	2	2	2	4	4	1	1
44	base insulation	2	2	2	2	2	2	2	2	2	2	2	2	4	4	1	1
45	bent connector	1	1	2	2	2	2	2	2	2	2	2	2	4	4	1	1
46	flat connector	1	1	2	2	2	2	2	2	2	2	2	2	4	4	1	1
47	terminal	1	1	2	2	2	2	2	2	4	4	4	4	8	8	2	2
48	shunt stud	1	1	2	2	2	2	2	2	1	1	1	1	2	2	1	1
49	mounting stud	1	1	2	2	2	2	2	2	1	1	1	1	2	2	1	1
△	coil screw	2	2	4	4	4	4	4	4	2	2	2	2	4	4	2	2

△ not illustrated.