



switchgear apparatus
 type 50-DH-150 "De-ion" air circuit breaker
 breaker unit
 600 ampere - 5000 volt - 3 pole

renewal
 parts da
 33-67
 sectic
 DH
 137048

style no. 1370 489

For typical illustration, see r.p.i. 33-670-1, section breaker unit; facing
the following parts are most subject to wear in ordinary operation: page ACB-50DH100-
 ref.

no.	name of part	identification number	numb per unit
..	breaker unit complete	1370 489	1
1	moving contact complete		3
2	contact arm	1221 942	3
3	arcing contact	1346 108	3
4	arcing contact bolt (item 20)	dwg.15a3757	9
5	main contact	1370 474	3
6	main contact spring	1221 790	6
7	elastic stop nut	1303 269	6
9	baffle - upper	1370 478	3
10	moving contact arm bearing	1370 485	3
11	hinge pin	885 593	3
12	moving contact shunt	1370 480	3
13	stationary arcing contact	1392 505	3
14	spring guide	1370 484	3
15	stationary arcing contact spring - outer	1370 481	3
15	stationary arcing contact spring - inner	1370 482	3
16	barrier - small	1370 486	3
17	barrier - large	1370 487	3
18	.190-32 x 3/8 flat head steel machine screw	std.hdw.	6
19	stationary arcing contact guide	1370 476	6
20	stationary arcing contact shunt	1332 654	3
21	shunt spring	1176 795	6
22	shunt screw - rear	1152 240	6
22	shunt screw - front	1198 886	6
23	insulating washer	1091 984	6
24	baffle - lower (group #2)	dwg.9b8011	3
25	stationary main contact with upper stud	1370 468	3
26	stationary main contact with lower stud	1370 469	3

Notes: Parts indented are included in the part under which they are indented. Order part by name and identification number — give complete nameplate reading.

supersedes issue dated March, 1951

effective August, 1953

www.ElectricalPartManuals.com

Supersedes Issue
Dated December, 1945
June, 1946

Renewal Parts Data 33-670
Section: Breaker Unit

Westinghouse Switchgear and Control Apparatus

THREE-POLE BREAKER UNIT
for
Type 50-DH-150 "De-ion" Air Circuit Breakers
1200 AMPERES - 5000 VOLTS
Style No. 1370 491

For Illustration, See R.P.D. 33-670-P, Section DH-PU;
facing page ACB-50DH150-1

Ref. No.	Description of Part	Style Number	No. Req.
..	Breaker Unit Complete	1370 491	1
1	Moving Contact Complete	...	1
2	Contact Arm	1221 943	3
3	Arcing Contact	1346 108	3
4	Arcing Contact Bolt (Item 20)	Dwg. 15A3758	9
5	Main Contact	1370 474	6
6	Main Contact Spring	1221 790	12
7	Elastic Stop Nut	1303 269	12
9	Upper Baffle	1370 478	3
10	Moving Contact Bearing	1370 485	3
11	Hinge Pin	885 593	3
12	Moving Contact Shunt	1370 480	3
13	Stationary Arcing Contact	1392 505	3
14	Stationary Arcing Contact Spring - Outer	1370 481	3
15	Stationary Arcing Contact Spring - Inner	1370 482	3
16	Barrier over Upper Stud - Small	1370 486	3
17	Barrier over Upper Stud - Large	1370 487	3
18	Binding Head Screw for Barriers	1288 577	6
*	Spring Guide	1370 484	3
19	Stationary Arcing Contact Guide	1370 476	6
20	Stationary Arcing Contact Shunt	1332 654	3
21	Shunt Spring	1176 795	6
*	Shunt Screw - Rear	1152 240	6
22	Shunt Screw - Front	1198 886	6
23	Insulating Washer	1091 984	6
24	Lower Baffle	1370 479	3
25	Stationary Main Contact and Upper Stud	1370 470	3
26	Stationary Main Contact and Lower Stud	1370 471	3

* Not illustrated

Parts indented are included in the part under which they are indented

ORDER PARTS BY DESCRIPTION AND STYLE NUMBER AND GIVE COMPLETE NAME
PLATE READING.

www.ElectricalPartManuals.com



type 50-DH-150-A "De-ion" air circuit breaker
 electrically operated - drawout mounting
 1200 ampere - 4.16 kv. - 60 cycle - 3 pole

renewal
 parts da

style no. 1574 358

the following parts are most subject to wear in ordinary operation:

name of part	identification number	number per unit
breaker complete	1574 358	1
breaker unit (page ACB-50DH150A-15)	1370 491	1
arc chamber	1370 466	3
arc chamber to stationary contact shunt	1332 617	3
cross bar	1533 975	1
operating rod	1533 942	3
operating mechanism (page CBM-3)	1585 844	1
closing coil - 125 volt d-c	676 629	1
main barrier	1370 531	1
blowout barrier	1370 495	3
mechanism panel	1448 368	1
solenoid cutoff switch	1418 855	1
operation counter	942 801	1
operation counter link	1448 350	1
shunt trip attachment	1533 980	1
shunt trip coil - 125 volt d-c	476 676	1
type W auxiliary switch - 9 pole (page S-W-A-22)	1481 651	1
primary disconnecting contact	1300 587	6
contact finger	1300 591	54
contact finger spring	1300 594	54
secondary and grounding contact (group #1)	dwg.23a3891	1
grounding contact	1166 621	1
secondary contact plug	1241 724	1
pin	1332 668	1
spring	1332 669	1
levering-in device (group #1)	dwg.23a3887	1

note: Parts indented are included in the part under which they are indented. Order part by name and identification number — give complete nameplate reading.

supersedes issue dated August, 1950

effective August, 1953

www.ElectricalPartManuals.com



type 50-DH-150-A "De-ion" air circuit breaker
 electrically operated - drawout mounting
 1200 ampere - 4.16 kv. - 60 cycle - 3 pole

renewal
 parts da

style no. 1574 359

the following parts are most subject to wear in ordinary operation:

name of part	identification number	number per unit
breaker complete	1574 359	1
breaker unit (page ACB-50DH150A-15)	1370 491	1
arc chamber	1370 466	3
arc chamber to stationary contact shunt	1332 617	3
cross bar	1533 975	1
operating rod	1533 942	3
operating mechanism (page CBM-3)	1585 844	1
closing coil - 250 volt d-c	676 624	1
main barrier	1370 531	1
blowout barrier	1370 495	3
mechanism panel	1448 368	1
solenoid cutoff switch	1418 855	1
operation counter	942 801	1
operation counter link	1448 350	1
shunt trip attachment	1533 980	1
shunt trip coil - 250 volt d-c	712 266	1
type W auxiliary switch - 9 pole (page S-W-A-22)	1481 651	1
primary disconnecting contact	1300 587	6
contact finger	1300 591	54
contact finger spring	1300 594	54
secondary and grounding disconnecting contact (group #1)	dwg.23a3891	1
grounding contact	1166 621	1
secondary contact plug	1241 724	1
pin	1332 668	1
spring	1332 669	1
levering-in device (group #1)	dwg.23a3887	1

note: Parts indented are included in the part under which they are indented. Order part by name and identification number - give complete nameplate reading.

supersedes issue dated August, 1950

effective August, 1953

www.ElectricalPartManuals.com



type 50-DH-150-A "De-ion" air circuit breaker
 electrically operated - drawout mounting
 1200 ampere - 4.16 kv. - 60 cycle - 3 pole

renewal
 parts da

style no. 1574 360

the following parts are most subject to wear in ordinary operation:

name of part	identification number	number per unit
breaker complete	1574 360	1
breaker unit (page ACB-50DH150A-15)	1370 491	1
arc chamber	1370 466	3
arc chamber to stationary contact shunt	1332 617	3
cross bar	1533 975	1
operating rod	1533 942	3
operating mechanism (page CBM-3)	1585 844	1
operating coil - 230 volt a-c	676 629	1
main barrier	1370 531	1
blowout barrier	1370 495	3
mechanism panel	1448 368	1
solenoid cutoff switch	1418 855	1
operation counter	942 801	1
operation counter link	1448 350	1
shunt trip attachment	1533 981	1
capacitor shunt trip coil	300 870	1
type W auxiliary switch - 9 pole (page S-W-A-22)	1481 651	1
primary disconnecting contact	1300 587	6
contact finger	1300 591	54
contact finger spring	1300 594	54
secondary and ground disconnecting contact (group #1)	dwg.23a3891	1
grounding contact	1166 621	1
secondary contact plug	1241 724	1
pin	1332 668	1
spring	1332 669	1
levering-in device (group #1)	dwg.23a3887	1
capacitor trip device	1254 358	1
rectox unit	1224 936	3
capacitor - 37.5 mfd.	1446 426	2
resistor - 2 megohm	791 850	1
transformer	1224 902	1
lamp receptacle	822 328	1
neon pilot lamp	1174 168	1
lens - clear	822 270	1
rectox rectifier	1491 499 ==	1
rectox unit	1116 690	1
resistor - 2 ohm	389 076	1

== not part of complete breaker style number

note: Parts indented are included in the part under which they are indented. Order part by name and identification number—give complete nameplate reading.

supersedes issue dated August, 1950

effective August, 1953

www.ElectricalPartManuals.com



type 50-DH-150-A "De-ion" air circuit breaker
 electrically operated - drawout mounting
 1200 ampere - 4.16 kv. - 60 cycle - 3 pole

renewal
 parts da

style no. 1574 361

the following parts are most subject to wear in ordinary operation:

name of part	identification number	numb per us
breaker complete	1574 361	1
breaker unit (page ACB-50DH150A-15)	1370 491	1
arc chamber	1370 466	3
arc chamber to stationary contact shunt	1332 617	3
cross bar	1533 975	1
operating rod	1533 942	3
operating mechanism (page CBM-3)	1585 844	1
closing coil - 230 volt a-c	676 629	1
main barrier	1370 531	1
blowout barrier	1370 495	3
mechanism panel	1448 368	1
solenoid cutoff switch	1418 855	1
operation counter	942 801	1
operation counter link	1448 350	1
shunt trip attachment	1533 980	1
shunt trip coil - 48 volt d-c	478 047	1
type W auxiliary switch - 9 pole (page S-W-A-22)	1481 651	1
primary disconnecting contact	1300 587	6
contact finger	1300 591	54
contact finger spring	1300 594	54
secondary and grounding disconnecting contact (group #1)	dwg.23a3891	1
grounding contact	1166 621	1
secondary contact plug	1241 724	1
pin	1332 668	1
spring	1332 669	1
levering-in device (group #1)	dwg.23a3887	1
rectox rectifier	1491 499	1
rectox unit	1116 690	1
resistor - 2 ohm	389 076	1

== not part of complete breaker style number

note: Parts indented are included in the part under which they are indented. Order part by name and identification number — give complete nameplate reading.

supersedes issue dated August, 1950

effective August, 1953

www.ElectricalPartManuals.com



type 50-DH-150-A "De-ion" air circuit breaker
 electrically operated - drawout mounting
 1200 ampere - 4.16 kv. - 60 cycle - 3 pole

renewal
 parts da

style no. 1574 362

the following parts are most subject to wear in ordinary operation:

name of part	identification number	numb per us
breaker complete	1574 362	1
breaker unit (page ACB-50DH150A-15)	1370 491	1
arc chamber	1370 466	3
arc chamber to stationary contact shunt	1332 617	3
cross bar	1533 975	1
operating rod	1533 942	3
operating mechanism (page CBM-3)	1585 844	1
closing coil - 230 volt a-c	676 629	1
main barrier	1370 531	1
blowout barrier	1370 495	3
mechanism panel	1448 368	1
solenoid cutoff switch	1418 855	1
operation counter	942 801	1
operation counter link	1448 350	1
shunt trip attachment	1533 980	1
shunt trip coil - 24 volt d-c	476 915	1
type W auxiliary switch - 9 pole (page S-W-A-22)	1481 651	1
primary disconnecting contact	1300 587	6
contact finger	1300 591	54
contact finger spring	1300 594	54
secondary and grounding disconnecting contact (group #1)	dwg.23a3891	1
grounding contact	1166 621	1
secondary contact plug	1241 724	1
pin	1332 668	1
spring	1332 669	1
levering-in device (group #1)	dwg.23a3887	1
rectox rectifier	1491 499 ==	1
rectox unit	1166 690	1
resistor - 2 ohm	389 076	1

== not part of complete breaker style number

note: Parts indented are included in the part under which they are indented. Order part by name and identification number — give complete nameplate reading.

supersedes issue dated August, 1950

effective August, 1953

www.ElectricalPartManuals.com



type 50-DH-150-A "De-ion" air circuit breaker
 electrically operated - drawout mounting
 1200 ampere - 4.16 kv. - 60 cycle - 3 pole

renewal
 parts d:

style no. 1574 363

the following parts are most subject to wear in ordinary operation:

name of part	identification number	quantity
breaker complete	1574 363	1
breaker unit (page ACB-50DH150A-15)	1370 491	1
arc chamber	1370 466	3
arc chamber to stationary contact shunt	1332 617	3
cross bar	1533 975	1
operating rod	1533 942	3
operating mechanism (page CBM-3)	1585 844	1
closing coil - 230 volt a-c	676 629	1
main barrier	1370 531	1
blowout barrier	1370 495	3
mechanism panel	1448 368	1
solenoid cutoff switch	1418 855	1
operation counter	942 801	1
operation counter link	1448 350	1
shunt trip attachment	1533 981	1
shunt trip coil - 230 volt a-c	478 047	1
type W auxiliary switch - 9 pole (page S-W-A-22)	1481 651	1
primary disconnecting contact	1300 587	6
contact finger	1300 591	54
contact finger spring	1300 594	54
secondary and grounding disconnecting contact (group #1)	dwg.23a3891	1
grounding contact	1166 621	1
secondary contact plug	1241 724	1
pin	1332 668	1
spring	1332 669	1
levering-in device (group #1)	dwg.23a3887	1
rectox rectifier	1491 499 ==	1
rectox unit	1116 690	1
resistor - 2 ohm	389 076	1

== not part of complete breaker style number

note: Parts indented are included in the part under which they are indented. Order part by name and identification number - give complete nameplate reading.

supersedes issue dated August, 1950

effective August, 1953

www.ElectricalPartManuals.com



type 50-DH-150-A "De-ion" air circuit breaker
 electrically operated - drawout mounting
 1200 ampere - 4.16 kv. - 60 cycle - 3 pole

renewal
 parts da

style no. 1574 364

the following parts are most subject to wear in ordinary operation:

name of part	identification number	number per unit
breaker complete	1574 364	1
breaker unit (page ACB-50DH150A-15)	1370 491	1
arc chamber	1370 466	3
arc chamber to stationary contact shunt	1332 617	3
cross bar	1533 975	1
operating rod	1533 942	3
operating mechanism (page CBM-3)	1585 844	1
closing coil - 125 volt d-c	676 629	1
main barrier	1370 531	1
blowout barrier	1370 495	3
mechanism panel	1448 368	1
solenoid cutoff switch	1418 855	1
operation counter	942 801	1
operation counter link	1448 350	1
shunt trip attachment	1533 980	1
shunt trip coil - 125 volt d-c	476 676	1
type W auxiliary switch - 9 pole (page S-W-A-22)	1481 651	1
primary disconnecting contact	1300 587	6
contact finger	1300 591	54
contact finger spring	1300 594	54
secondary and grounding disconnecting contact (group #1)	dwg.23a3891	1
grounding contact	1166 621	1
secondary contact plug	1241 724	1
pin	1332 668	1
spring	1332 669	1
levering-in device (group #1)	dwg.23a3887	1
latch checking switch	1533 982	1

note: Parts indented are included in the part under which they are indented. Order part by name and identification number - give complete nameplate reading.

supersedes issue dated August, 1950

effective August, 1953

www.ElectricalPartManuals.com



type 50-DH-150-A "De-ion" air circuit breaker
 electrically operated - drawout mounting
 1200 ampere - 4.16 kv. - 60 cycle - 3 pole

renewal
 parts da

style no. 1574 365

the following parts are most subject to wear in ordinary operation:

name of part	identification number	numb per u
breaker complete	1574 365	1
breaker unit (page ACB-50DH150A-15)	1370 491	1
arc chamber	1370 466	3
arc chamber to stationary contact shunt	1332 617	3
cross bar	1533 975	1
operating rod	1533 942	3
operating mechanism (page CBM-3)	1585 844	1
closing coil - 250 volt d-c	676 624	1
main barrier	1370 531	1
blowout barrier	1370 495	3
mechanism panel	1448 368	1
solenoid cutoff switch	1418 855	1
operation counter	942 801	1
operation counter link	1448 350	1
shunt trip attachment	1533 980	1
shunt trip coil - 250 volt d-c	712 266	1
type W auxiliary switch - 9 pole (page S-W-A-22)	1481 651	1
primary disconnecting contact	1300 587	6
contact finger	1300 591	54
contact finger spring	1300 594	54
secondary and grounding disconnecting contact (group #1)	dwg.23a3891	1
grounding contact	1166 621	1
secondary contact plug	1241 724	1
pin	1332 668	1
spring	1332 669	1
levering-in device (group #1)	dwg.23a3887	1
latch checking switch	1533 982	1

note: Parts indented are included in the part under which they are indented. Order part by name and identification number — give complete nameplate reading.

supersedes issue dated August, 1950

effective August, 1953

www.ElectricalPartManuals.com



type 50-DH-150-A "De-ion" air circuit breaker
 electrically operated - drawout mounting
 1200 ampere - 4.16 kv. - 60 cycle - 3 pole

renewal
 parts da

style no. 1574 366

the following parts are most subject to wear in ordinary operation:

name of part	identification number	numb per us
breaker complete	1574 366	1
breaker unit (page ACB-50DH150A-15)	1370 491	1
arc chamber	1370 466	3
arc chamber to stationary contact shunt	1332 617	3
cross bar	1533 975	1
operating rod	1533 942	3
operating mechanism (page CBM-3)	1585 844	1
closing coil - 230 volt a-c	676 629	1
main barrier	1370 531	1
blowout barrier	1370 495	3
mechanism panel	1448 368	1
solenoid cutoff switch	1418 855	1
operation counter	942 801	1
operation counter link	1448 350	1
shunt trip attachment	1533 981	1
capacitor shunt trip coil	300 870	1
type W auxiliary switch - 9 pole (page S-W-A-22)	1481 651	1
primary disconnecting contact	1300 587	6
contact finger	1300 591	54
contact finger spring	1300 594	54
secondary and grounding disconnecting contact (group #1)	dwg.23a3891	1
grounding contact	1166 621	1
secondary contact plug	1241 724	1
pin	1332 668	1
spring	1332 669	1
levering-in device (group #1)	dwg.23a3887	1
capacitor trip device	1254 358	1
rectox unit	1224 936	3
capacitor - 37.5 mfd.	1446 426	2
resistor - 2 megohm	791 850	1
transformer	1224 902	1
lamp receptacle	822 328	1
neon pilot lamp	1174 168	1
lens - clear	822 270	1
latch checking switch	1533 982	1
rectox rectifier	1491 499	== 1
rectox unit	1116 690	1
resistor - 2 ohm	389 076	1

== not part of complete breaker style number

note: Parts indented are included in the part under which they are indicated. Order part by name and identification number - give complete nameplate reading.

supersedes issue dated August, 1950

effective August, 1953

www.ElectricalPartManuals.com



type 50-DH-150-A "De-ion" air circuit breaker
 electrically operated - drawout mounting
 1200 ampere - 4.16 kv. - 60 cycle - 3 pole

renewal
 parts d:

style no. 1574 367

the following parts are most subject to wear in ordinary operation:

name of part	identification number	number per unit
breaker complete	1574 367	1
breaker unit (page ACB-50DH150A-15)	1370 491	1
arc chamber	1370 466	3
arc chamber to stationary contact shunt	1332 617	3
cross bar	1533 975	1
operating rod	1533 942	3
operating mechanism (page CBM-3)	1585 844	1
closing coil - 230 volt a-c	676 629	1
main barrier	1370 531	1
blowout barrier	1370 495	3
mechanism panel	1448 368	1
solenoid cutoff switch	1418 855	1
operation counter	942 801	1
operation counter link	1448 350	1
shunt trip attachment	1533 980	1
shunt trip coil - 48 volt d-c	478 047	1
type W auxiliary switch - 9 pole (page S-W-A-22)	1481 651	1
primary disconnecting contact	1300 587	6
contact finger	1300 591	54
contact finger spring	1300 594	54
secondary and grounding disconnecting contact (group #1)	dwg.23a3891	1
grounding contact	1166 621	1
secondary contact plug	1241 724	1
pin	1332 668	1
spring	1332 669	1
levering-in device (group #1)	dwg.23a3887	1
latch checking switch	1533 982	1
rectox rectifier	1491 499 ==	1
rectox unit	1116 690	1
resistor - 2 ohm	389 076	1

== not part of complete breaker style number

note: Parts indented are included in the part under which they are indented. Order part by name and identification number-- give complete nameplate reading.

supersedes issue dated August, 1950

effective August, 1953

www.ElectricalPartManuals.com



type 50-DH-150-A "De-ion" air circuit breaker
 electrically operated - drawout mounting
 1200 ampere - 4.16 kv. - 60 cycle - 3 pole

renewal
 parts da

style no. 1574 368

the following parts are most subject to wear in ordinary operation:

name of part	identification number	numb per ur
breaker complete	1574 368	1
breaker unit (page ACB-50DH150A-15)	1370 491	1
arc chamber	1370 466	3
arc chamber to stationary contact shunt	1332 617	3
cross bar	1533 975	1
operating rod	1533 942	3
operating mechanism (page CBM-3)	1585 844	1
closing coil - 230 volt a-c	676 629	1
main barrier	1370 531	1
blowout barrier	1370 495	3
mechanism panel	1448 368	1
solenoid cutoff switch	1418 855	1
operation counter	942 801	1
operation counter link	1448 350	1
shunt trip attachment	1533 980	1
shunt trip coil - 24 volt d-c	476 915	1
type W auxiliary switch - 9 pole (page S-W-A-22)	1481 651	1
primary disconnecting contact	1300 587	6
contact finger	1300 591	54
contact finger spring	1300 594	54
secondary and grounding disconnecting contact (group #1)	dwg.23a3891	1
grounding contact	1166 621	1
secondary contact plug	1241 724	1
pin	1332 668	1
spring	1332 669	1
levering-in device (group #1)	dwg.23a3887	1
latch checking switch	1533 982	1
rectox rectifier	1491 499 ==	1
rectox unit	1116 690	1
resistor - 2 ohm	389 076	1

== not part of complete breaker style number

notes: Parts indented are included in the part under which they are indented. Order part by name and identification number - give complete nameplate reading.

supersedes issue dated August, 1950

effective August, 1953

www.ElectricalPartManuals.com



type 50-DH-150-A "De-ion" air circuit breaker
 electrically operated - drawout mounting
 1200 ampere - 4.16 kv. - 60 cycle - 3 pole

renewal
 parts data

style no. 1574 369

the following parts are most subject to wear in ordinary operation:

name of part	identification number	number per unit
breaker complete	1574 369	1
breaker unit (page ACB-50DH150A-15)	1370 491	1
arc chamber	1370 466	3
arc chamber to stationary contact shunt	1332 617	3
cross bar	1533 975	1
operating rod	1533 942	3
operating mechanism (page CBM-3)	1585 844	1
closing coil - 230 volt a-c	676 629	1
main barrier	1370 531	1
blowout barrier	1370 495	3
mechanism panel	1448 368	1
solenoid cutoff switch	1418 855	1
operation counter	942 801	1
operation counter link	1448 350	1
shunt trip attachment	1533 981	1
shunt trip coil - 230 volt a-c	478 047	1
type W auxiliary switch - 9 pole (page S-W-A-22)	1481 651	1
primary disconnecting contact	1300 587	6
contact finger	1300 591	54
contact finger spring	1300 594	54
secondary and grounding disconnecting contact (group #1)	dwg. 23a3891	1
grounding contact	1166 621	1
secondary contact plug	1241 724	1
pin	1332 668	1
spring	1332 669	1
levering-in device (group #1)	dwg. 23a3887	1
latch checking switch	1533 982	1
rectox rectifier	1491 499 ==	1
rectox unit	1116 690	1
resistor - 2 ohm	389 076	1

== not part of complete breaker style number

note: Parts indented are included in the part under which they are indented. Order part by name and identification number - give complete nameplate reading.

supersedes issue dated August, 1950

effective August, 1953

www.ElectricalPartManuals.com



type 50-DH-150-A "De-ion" air circuit breaker
 electrically operated - drawout mounting
 1200 ampere - 4.16 kv. - 60 cycle - 3 pole

renewal
 parts da

style no. 1574 370

the following parts are most subject to wear in ordinary operation:

name of part	identification number	numb. per unit
breaker complete	1574 370	1
breaker unit (page ACB-50DH150A-15)	1370 491	1
arc chamber	1370 466	3
arc chamber to stationary contact shunt	1332 617	3
cross bar	1533 975	1
operating rod	1533 942	3
operating mechanism (page CBM-4)	1648 091	1
closing coil - 230 volt a-c	676 629	1
main barrier	1370 531	1
blowout barrier	1370 495	3
mechanism panel	1448 368	1
solenoid cutoff switch	1418 855	1
operation counter	942 801	1
operation counter link	1448 350	1
shunt trip attachment	1533 981	1
shunt trip coil - 230 volt a-c	478 047	1
type W auxiliary switch - 9 pole (page S-W-A-22)	1481 651	1
primary disconnecting contact	1300 587	6
contact finger	1300 591	54
contact finger spring	1300 594	54
secondary and grounding disconnecting contact (group #1)	dwg.23a3891	1
grounding contact	1166 621	1
secondary contact plug	1241 724	1
pin	1332 668	1
spring	1332 669	1
levering-in device (group #1)	dwg.23a3887	1
undervoltage trip	1584 808	1
compression spring	1584 401	1
torsion spring	1589 394	1
coil for above	1019 285	1
undervoltage time delay device	1087 206	1
transformer - 550 volt	1091 238	1
rectox unit	971 430	3
capacitor - 37.5 mfd.	1446 426	1
resistor - 5000 ohm	1250 335	3
resistor - 25000 ohm (Ohmite Brown Devil 10 watt)	...	1
rectox rectifier	1491 499 ==	1
rectox unit	1116 690	1
resistor - 2 ohm	389 076	1

notes: Parts indented are included in the part under which they are indented. Order part by name and identification number - give complete nameplate reading.

== not part of complete breaker style number

supersedes issue dated May, 1952

effective August, 1953

www.ElectricalPartManuals.com



type 50-DH-150-A "De-ion" air circuit breaker
 electrically operated - drawout mounting
 1200 ampere - 4.16 kv. - 60 cycle - 3 pole

renewal
 parts da

style no. 1574 371

the following parts are most subject to wear in ordinary operation:

name of part	identification number	numb per un
breaker complete	1574 371	1
breaker unit (page ACB-50DH150A-15)	1370 491	1
arc chamber	1370 466	3
arc chamber to stationary contact shunt	1332 617	3
cross bar	1533 975	1
operating rod	1533 942	3
operating mechanism (page CBM-4)	1648 091	1
closing coil - 230 volt a-c	676 629	1
main barrier	1370 531	1
blowout barrier	1370 495	3
mechanism panel	1448 368	1
solenoid cutoff switch	1418 855	1
operation counter	942 801	1
operation counter link	1448 350	1
shunt trip attachment	1533 981	1
shunt trip coil - 230 volt a-c	478 047	1
type W auxiliary switch - 9 pole (page S-W-A-22)	1481 651	1
primary disconnecting contact	1300 587	6
contact finger	1300 591	54
contact finger spring	1300 594	54
secondary and grounding disconnecting contact (group #1)	dwg 23a3891	1
grounding contact	1166 621	1
secondary contact plug	1251 724	1
pin	1332 668	1
spring	1332 669	1
levering-in device (group #1)	dwg.23a3887	1
undervoltage trip	1584 808	1
compression spring	1589 401	1
torsion spring	1589 394	1
coil for above	945 084	1
transformer and rectox	1227 233	1
rectox unit	971 299	1
transformer	1227 527	1
rectox rectifier	1491 499	1
rectox unit	1116 690	1
resistor - 2 ohm	389 076	1

== not part of complete breaker style number

note: Parts indented are included in the part under which they are indented. Order part by name and identification number—give complete nameplate reading.

supersedes issue dated May, 1952

effective August, 1953

www.ElectricalPartManuals.com

renewal parts
illustration

33-670-1
section
breaker unit

air circuit breaker
type DH
three pole breaker unit



switchgear apparatus

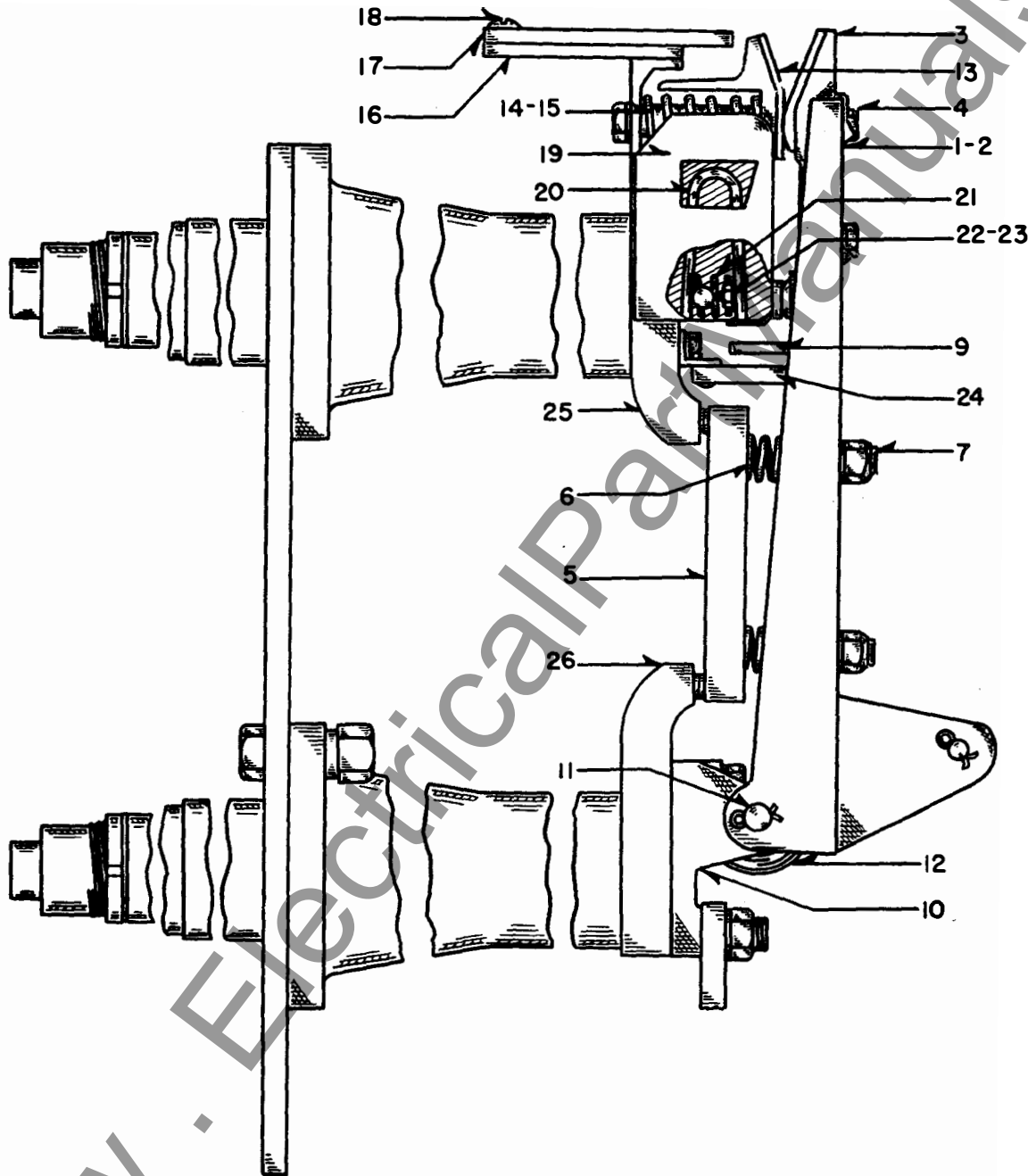

supersedes R P D 33-670-P1
dated April, 1950

effective February, 1952

Westinghouse Electric Corporation · Switchgear Division · East Pittsburgh, Pennsylvania

www.ElectricalPartManuals.com



type 50-DH-150-A "De-ion" air circuit breaker
breaker unit

1200 ampere - 4.16 kv. - 3 pole

style no. 1370 491

renewal
parts da
33-670
sectic
137049

For typical illustration, see r.p.i. 33-670-1, section breaker unit; facing
the following parts are most subject to wear in ordinary operation: page ACB-50DH150A

ref. no.	name of part	identification number	15	numb per un
..	breaker unit	1370 491		1
1	moving contact complete		3
2	contact arm	1221 943		3
3	arcing contact	1346 108		3
4	arcing contact bolt (item 20)	dwg.15a3758		9
5	main contact	1370 474		6
6	main contact spring	1221 790		12
7	elastic stop nut	1303 269		12
9	upper baffle	1370 478		3
10	moving contact bearing	1370 485		3
11	hinge pin	885 593		3
12	moving contact shunt	1370 480		3
13	stationary arcing contact	1392 505		3
14	spring guide	1370 484		3
15	stationary arcing contact spring - outer	1370 481		3
15	stationary arcing contact spring - inner	1370 482		3
16	small barrier	1370 486		3
17	large barrier	1370 487		3
18	.190-32 x 3/8" flat head machine screw	std.hdw.		6
19	stationary arcing contact guide	1370 476		6
20	stationary arcing contact shunt	1332 654		3
21	shunt spring	1176 795		6
22	shunt screw - rear (item 37)	dwg.15a3758		6
22	shunt screw - front (item 41)	dwg.15a3758		6
23	insulating washer	1091 984		6
24	lower baffle	1370 479		3
25	stationary main contact with upper stud	1370 470		3
26	stationary main contact with lower stud	1370 471		3

note: Parts indented are included in the part under which they are indented. Order part by name and identification number — give complete nameplate reading.

supersedes issue dated October, 1952

effective August, 1953

www.ElectricalPartManuals.com



type 50-DH-150-A "De-ion" air circuit breaker
 electrically operated - drawout mounting
 2000 ampere - 4.16 kv. - 60 cycle - 3 pole

renewal
 parts da

style no. 1574 372

the following parts are most subject to wear in ordinary operation:

name of part	identification number	number per unit
breaker complete	1574 372	1
breaker unit (page ACB-50DH150A-30)	1572 451	1
arc chamber	1370 466	3
arc chamber to stationary contact shunt	1444 857	3
cross bar	1533 976	1
operating rod	1533 942	3
operating mechanism (page CBM-3)	1585 844	1
closing coil - 125 volt d-c	676 629	1
main barrier	1446 172	1
blowout barrier	1444 845	3
mechanism panel	1448 368	1
solenoid cutoff switch	1418 855	1
operation counter	942 801	1
operation counter link	1448 350	1
shunt trip attachment	1533 980	1
shunt trip coil - 125 volt d-c	476 676	1
type W auxiliary switch - 9 pole (page S-W-A-22)	1481 651	1
primary disconnecting contact	1572 122	6
contact finger	1300 589	90
contact finger spring	1300 592	90
secondary and grounding disconnecting contact (group #1)	dwg.23a3891	1
grounding contact	1166 621	1
secondary contact plug	1241 724	1
pin	1332 668	1
spring	1332 669	1
levering-in device (group #1)	dwg.23a3896	1

note: Parts indented are included in the part under which they are indented. Order part by name and identification number—give complete nameplate reading.

supersedes issue dated August, 1950

effective August, 1953

www.ElectricalPartManuals.com



type 50-DH-150-A "De-ion" air circuit breaker
 electrically operated - drawout mounting
 2000 ampere - 4.16 kv. - 60 cycle - 3 pole

renewal
 parts da

style no. 1574 373

the following parts are most subject to wear in ordinary operation:

name of part	identification number	numb per ur
breaker complete	1574 373	1
breaker unit (page ACB-50DH150A-30)	1572 451	1
arc chamber	1370 466	3
arc chamber to stationary contact shunt	1444 857	3
cross bar	1533 976	1
operating rod	1533 942	3
operating mechanism (page CBM-3)	1585 844	1
closing coil - 250 volt d-c	676 624	1
main barrier	1446 172	1
blowout barrier	1444 845	3
mechanism panel	1448 368	1
solenoid cutoff switch	1418 855	1
operation counter	942 801	1
operation counter link	1448 350	1
shunt trip attachment	1533 980	1
shunt trip coil - 250 volt d-c	712 266	1
type W auxiliary switch - 9 pole (page S-W-A-22)	1481 651	1
primary disconnecting contact	1572 122	6
contact finger	1300 589	90
contact finger spring	1300 592	90
secondary and grounding disconnecting contact (group #1)	dwg.23a2891	1
grounding contact	1166 621	1
secondary contact plug	1241 724	1
pin	1332 668	1
spring	1332 669	1
levering-in device (group #1)	dwg.23a3896	1

note: Parts indented are included in the part under which they are indented. Order part by name and identification number — give complete nameplate reading.

supersedes issue dated August, 1950

effective August, 1953

www.ElectricalPartManuals.com



type 50-DH-150-A "De-ion" air circuit breaker
 electrically operated - drawout mounting
 2000 ampere - 4.16 kv. - 60 cycle - 3 pole

renewal
 parts dat

style no. 1574 374

the following parts are most subject to wear in ordinary operation:

name of part	identification number	number per unit
breaker complete	1574 374	1
breaker unit (page ACB-50DH150A-30)	1572 451	1
arc chamber	1370 466	3
arc chamber to stationary contact shunt	1444 857	3
cross bar	1533 976	1
operating rod	1533 942	3
operating mechanism (page CBM-3)	1585 844	1
closing coil - 230 volt a-c	676 629	1
main barrier	1446 172	1
blowout barrier	1444 845	3
mechanism panel	1448 368	1
solenoid cutoff switch	1418 855	1
operation counter	942 801	1
operation counter link	1448 350	1
shunt trip attachment	1533 981	1
capacitor shunt trip coil	300 870	1
type W auxiliary switch - 9 pole (page S-W-A-22)	1481 651	1
primary disconnecting contact	1572 122	6
contact finger	1300 589	90
contact finger spring	1300 592	90
secondary and grounding disconnecting contact (group #1)	dwg.23a3891	1
grounding contact	1166 621	1
secondary contact plug	1241 724	1
pin	1332 668	1
spring	1332 669	1
levering-in device (group #1)	dwg.23a3896	1
capacitor trip device	1254 358	1
rectox unit	1224 936	3
capacitor - 37.5 mfd.	1446 426	2
resistor - 2 megohm	791 850	1
transformer	1224 902	1
lamp receptacle	822 328	1
neon pilot lamp	1174 168	1
lens - clear	822 270	1
rectox rectifier	1491 499==	1
rectox unit	1116 690	1
resistor - 2 ohm	389 076	1

== not part of complete breaker style number

note: Parts indented are included in the part under which they are indented. Order part by name and identification number—give complete nameplate reading.

supersedes issue dated August, 1950

effective August, 1953

www.ElectricalPartManuals.com



type 50-DH-150-A "De-ion" air circuit breaker
 electrically operated - drawout mounting
 2000 ampere - 4.16 kv. - 60 cycle - 3 pole

renewal
 parts data

style no. 1574 375

the following parts are most subject to wear in ordinary operation:

name of part	identification number	number per unit
breaker complete	1574 375	1
breaker unit (page ACB-50DH150A-30)	1572 451	1
arc chamber	1370 466	3
arc chamber to stationary contact shunt	1444 857	3
cross bar	1533 976	1
operating rod	1533 942	3
operating mechanism (page CBM-3)	1585 844	1
closing coil - 230 volt a-c	676 629	1
main barrier	1446 172	1
blowout barrier	1444 845	3
mechanism panel	1448 368	1
solenoid cutoff switch	1418 855	1
operation counter	942 801	1
operation counter link	1448 350	1
shunt trip attachment	1533 980	1
shunt trip coil - 48 volt d-c	478 047	1
type W auxiliary switch - 9 pole (page S-W-A-22)	1481 651	1
primary disconnecting contact	1572 122	6
contact finger	1300 589	90
contact finger spring	1300 592	90
secondary and grounding disconnecting contact (group #1)	dwg.23a3891	1
grounding contact	1166 621	1
secondary contact plug	1241 724	1
pin	1332 668	1
spring	1332 669	1
levering-in device (group #1)	dwg.23a3896	1
rectox rectifier	1491 499 ==	1
rectox unit	1116 690	1
resistor - 2 ohm	389 076	1

== not part of complete breaker style number

note: Parts indented are included in the part under which they are indented. Order part by name and identification number - give complete nameplate reading.

supersedes issue dated August, 1950

effective August, 1953

www.ElectricalPartManuals.com



type 50-DH-150-A "De-ion" air circuit breaker
 electrically operated - drawout mounting
 2000 ampere - 4.16 kv. - 60 cycle - 3 pole

renewal
 parts da

style no. 1574 376

the following parts are most subject to wear in ordinary operation:

name of part	identification number	numb per us
breaker complete	1574 376	1
breaker unit (page ACB-50DH150A-30)	1572 451	1
arc chamber	1370 466	3
arc chamber to stationary contact shunt	1444 857	3
cross bar	1533 976	1
operating rod	1533 942	3
operating mechanism (page CBM-3)	1585 844	1
closing coil - 230 volt a-c	676 629	1
main barrier	1446 172	1
blowout barrier	1444 845	3
mechanism panel	1448 368	1
solenoid cutoff switch	1418 855	1
operation counter	942 801	1
operation counter link	1448 350	1
shunt trip attachment	1533 980	1
shunt trip coil - 24 volt d-c	476 915	1
type W auxiliary switch - 9 pole (page S-W-A-22)	1481 651	1
primary disconnecting contact	1572 122	6
contact finger	1300 589	90
contact finger spring	1300 592	90
secondary and grounding disconnecting contact (group #1)	dwg.23a3891	1
grounding contact	1166 621	1
secondary contact plug	1241 724	1
pin	1332 668	1
spring	1332 669	1
levering-in device (group #1)	dwg.23a3896	1
rectox rectifier	1491 499 ==	1
rectox unit	1116 690	1
resistor - 2 ohm	389 076	1

== not part of complete breaker style number

note: Parts indented are included in the part under which they are indented. Order part by name and identification number — give complete nameplate reading.

supersedes issue dated August, 1950

effective August, 1953

www.ElectricalPartManuals.com



type 50-DH-150-A "De-ion" air circuit breaker
 electrically operated - drawout mounting
 2000 ampere - 4.16 kv. - 60 cycle - 3 pole

renewal
 parts data

style no. 1574 377

the following parts are most subject to wear in ordinary operation:

name of part	identification number	number per unit
breaker complete	1574 377	1
breaker unit (page ACB-50DH150A-30)	1572 451	1
arc chamber	1370 466	3
arc chamber to stationary contact shunt	1444 857	3
cross bar	1533 976	1
operating rod	1533 942	3
operating mechanism (page CBM-3)	1585 844	1
closing coil - 230 volt a-c	676 629	1
main barrier	1446 172	1
blowout barrier	1444 845	3
mechanism panel	1448 368	1
solenoid cutoff switch	1418 855	1
operation counter	942 801	1
operation counter link	1448 350	1
shunt trip attachment	1533 981	1
shunt trip coil - 230 volt a-c	478 047	1
type W auxiliary switch - 9 pole (page S-W-A-22)	1481 651	1
primary disconnecting contact	1572 122	6
contact finger	1300 589	90
contact finger spring	1300 592	90
secondary and grounding disconnecting contact (group #1)	dwg.23a3891	1
grounding contact	1166 621	1
secondary contact plug	1241 724	1
pin	1332 668	1
spring	1332 669	1
levering-in device (group #1)	dwg.23a3896	1
rectox rectifier	1491 499 ==	1
rectox unit	1116 690	1
resistor - 2 ohm	389 076	1

== not part of complete breaker style number

notes: Parts indented are included in the part under which they are indented. Order part by name and identification number—give complete nameplate reading.

supersedes issue dated August 1950

effective August, 1953

www.ElectricalPartManuals.com



type 50-DH-150-A "De-ion" air circuit breaker
 electrically operated - drawout mounting
 2000 ampere - 4.16 kv. - 60 cycle - 3 pole

renewal
 parts da

style no. 1574 378

the following parts are most subject to wear in ordinary operation:

name of part	identification number	number per unit
breaker complete	1574 378	1
breaker unit (page ACB-50DH150A-30)	1572 451	1
arc chamber	1370 466	3
arc chamber to stationary contact shunt	1444 857	3
cross bar	1533 976	1
operating rod	1533 942	3
operating mechanism (page CBM-3)	1585 844	1
closing coil - 125 volt d-c	676 629	1
main barrier	1446 172	1
blowout barrier	1444 845	3
mechanism panel	1448 368	1
solenoid cutoff switch	1418 855	1
operation counter	942 801	1
operation counter link	1448 350	1
shunt trip attachment	1533 980	1
shunt trip coil - 125 volt d-c	476 676	1
type W auxiliary switch - 9 pole (page S-W-A-22)	1481 651	1
primary disconnecting contact	1572 122	6
contact finger	1300 589	90
contact finger spring	1300 592	90
secondary and grounding disconnecting contact (group #1)	dwg.23a3891	1
grounding contact	1116 621	1
secondary contact plug	1241 724	1
pin	1332 668	1
spring	1332 669	1
levering-in device (group #1)	dwg.23a3896	1
latch checking switch	1533 982	1

note: Parts indented are included in the part under which they are indented. Order part by name and identification number — give complete nameplate reading.

supersedes issue dated August, 1950

effective August, 1953

www.ElectricalPartManuals.com



type 50-DH-150-A "De-ion" air circuit breaker
 electrically operated - drawout mounting
 2000 ampere - 4.16 kv. - 60 cycle - 3 pole

renewal
 parts da

style no. 1574 379

the following parts are most subject to wear in ordinary operation:

name of part	identification number	number per unit
breaker complete	1574 379	1
breaker unit (page ACB-50DH150A-30)	1572 451	1
arc chamber	1370 466	3
arc chamber to stationary contact shunt	1444 857	3
cross bar	1533 976	1
operating rod	1533 942	3
operating mechanism (page CBM-3)	1585 844	1
closing coil - 250 volt d-c	676 624	1
main barrier	1446 172	1
blowout barrier	1444 845	3
mechanism panel	1448 368	1
solenoid cutoff switch	1418 855	1
operation counter	942 801	1
operation counter link	1448 350	1
shunt trip attachment	1533 980	1
shunt trip coil - 250 volt d-c	712 266	1
type W auxiliary switch - 9 pole (page S-W-A-22)	1481 651	1
primary disconnecting contact	1572 122	6
contact finger	1300 589	90
contact finger spring	1300 592	90
secondary and grounding disconnecting contact (group #1)	dwg.23a3891	1
grounding contact	1166 621	1
secondary contact plug	1241 724	1
pin	1332 668	1
spring	1332 669	1
levering-in device (group #1)	dwg.23a3896	1
latch checking switch	1533 982	1

note: Parts indented are included in the part under which they are indented. Order part by name and identification number—give complete nameplate reading.

supersedes issue dated August, 1950

effective August, 1953

www.ElectricalPartManuals.com



type 50-DH-150-A "De-ion" air circuit breaker
 electrically operated - drawout mounting
 2000 ampere - 4.16 kv. - 60 cycle - 3 pole

renewal
 parts data

style no. 1574 380

the following parts are most subject to wear in ordinary operation:

name of part	identification number	number per unit
breaker complete	1574 380	1
breaker unit (page ACB-50DH150A-30)	1572 451	1
arc chamber	1370 466	3
arc chamber to stationary contact	1444 857	3
cross bar	1533 976	1
operating rod	1533 942	3
operating mechanism (page CBM-3)	1585 844	1
closing coil - 230 volt a-c	676 629	1
main barrier	1446 172	1
blowout barrier	1444 845	3
mechanism panel	1448 368	1
solenoid cutoff switch	1418 855	1
operation counter	942 801	1
operation counter link	1448 350	1
shunt trip attachment	1533 981	1
capacitor shunt trip coil	300 870	1
type W auxiliary switch - 9 pole (page S-W-A-22)	1481 651	1
primary disconnecting contact	1572 122	6
contact finger	1300 589	90
contact finger spring	1300 592	90
secondary and grounding disconnecting contact (group #1)	dwg.23a3891	1
grounding contact	1166 621	1
secondary contact plug	1241 724	1
pin	1332 668	1
spring	1332 669	1
levering-in device (group #1)	dwg.23a3896	1
capacitor trip device	1254 358	1
rectox unit	1224 936	3
capacitor - 37.5 mfd.	1446 426	2
resistor - 2 megohm	791 850	1
transformer	1224 902	1
lamp receptacle	822 328	1
neon pilot lamp	1174 168	1
lens - clear	822 270	1
latch checking switch	1533 982	1
rectox rectifier	1491 499 ==	1
rectox unit	1116 690	1
resistor - 2 ohm	389 076	1

== not part of complete breaker style number

note: Parts indented are included in the part under which they are indented. Order part by name and identification number—give complete nameplate reading.

supersedes issue dated August, 1950

effective August, 1953

www.ElectricalPartManuals.com



type 50-DH-150-A "De-ion" air circuit breaker
 electrically operated - drawout mounting
 2000 ampere - 4.16 kv. - 60 cycle - 3 pole

renewal
 parts da

style no 1574 381

the following parts are most subject to wear in ordinary operation:

name of part	identification number	number per unit
breaker complete	1574 381	1
breaker unit (page ACB-50DH150A-30)	1572 451	1
arc chamber	1370 466	3
arc chamber to stationary contact shunt	1444 857	3
cross bar	1533 976	1
operating rod	1533 942	3
operating mechanism (page CBM-3)	1585 844	1
closing coil - 230 volt a-c	676 629	1
main barrier	1446 172	1
blowout barrier	1444 845	3
mechanism panel	1448 368	1
solenoid cutoff switch	1418 855	1
operation counter	942 801	1
operation counter link	1448 350	1
shunt trip attachment	1533 980	1
shunt trip coil - 48 volt d-c	478 047	1
type W auxiliary switch - 9 pole (page S-W-A-22)	1481 651	1
primary disconnecting contact	1572 122	6
contact finger	1300 589	90
contact finger spring	1300 592	90
secondary and grounding disconnecting contact (group #1)	dwg.23a3891	1
grounding contact	1166 621	1
secondary contact plug	1241 724	1
pin	1332 668	1
spring	1332 669	1
levering-in device (group #1)	dwg.23a3896	1
latch checking switch	1533 982	1
rectox rectifier	1491 499 ==	1
rectox unit	1116 690	1
resistor - 2 ohm	389 076	1

== not part of complete breaker style number

note: Parts indented are included in the part under which they are indented. Order part by name and identification number - give complete nameplate reading.

supersedes issue dated August, 1950

effective August, 1953

www.ElectricalPartManuals.com



type 50-DH-150-A "De-ion" air circuit breaker
 electrically operated - drawout mounting
 2000 ampere - 4.16 kv. -60 cycle - 3 pole

renewal
 parts da

style no. 1574 382

the following parts are most subject to wear in ordinary operation:

same of part	identification number	numb per us
breaker complete	1574 382	1
breaker unit (page ACB-50DH150A-30)	1572 451	1
arc chamber	1370 466	3
arc chamber to stationary contact shunt	1444 857	3
cross bar	1533 976	1
operating rod	1533 942	3
operating mechanism (page CBM-3)	1585 844	1
closing coil - 230 volt a-c	676 629	1
main barrier	1446 172	1
blowout barrier	1444 845	3
mechanism panel	1448 368	1
solenoid cutoff switch	1418 855	1
operation counter	942 801	1
operation counter link	1448 350	1
shunt trip attachment	1533 980	1
shunt trip coil - 24 volt d-c	476 915	1
type W auxiliary switch - 9 pole (page S-W-A-22)	1481 651	1
primary disconnecting contact	1572 122	6
contact finger	1300 589	90
contact finger spring	1300 592	90
secondary and grounding disconnecting contact (group #1)	dwg.23a3891	1
grounding contact	1166 621	1
secondary contact plug	1241 724	1
pin	1332 668	1
spring	1332 669	1
levering-in device (group #1)	dwg.23a3896	1
latch checking switch	1533 982	1
rectox rectifier	1491 499	1
rectox unit	1116 690	1
resistor - 2 ohm	389 076	1

== not part of complete breaker style number

note: Parts indented are included in the part under which they are indented. Order part by name and identification number — give complete nameplate reading.

supersedes issue dated August, 1950

effective August, 1953

www.ElectricalPartManuals.com



type 50-DH-150-A "De-ion" air circuit breaker
 electrically operated - drawout mounting
 2000 ampere - 4.16 kv. - 60 cycle - 3 pole

renewal
 parts dat

style no. 1574 383

the following parts are most subject to wear in ordinary operation:

name of part	identification number	number per unit
breaker complete	1574 383	1
breaker unit (page ACB-50DH150A-30)	1572 451	1
arc chamber	1370 466	3
arc chamber to stationary contact shunt	1444 857	3
cross bar	1533 976	1
operating rod	1533 942	3
operating mechanism (page CBM-3)	1585 844	1
closing coil - 230 volt a-c	676 629	1
main barrier	1446 172	1
blowout barrier	1444 845	3
mechanism panel	1448 368	1
solenoid cutoff switch	1418 855	1
operation counter	942 801	1
operation counter link	1448 350	1
shunt trip attachment	1533 981	1
shunt trip coil - 230 volt a-c	478 047	1
type W auxiliary switch - 9 pole (page S-W-A-22)	1481 651	1
primary disconnecting contact	1572 122	6
contact finger	1300 589	90
contact finger spring	1300 592	90
secondary and grounding disconnecting contact (group #1)	dwg.23a3891	1
grounding contact	1166 621	1
secondary contact plug	1241 724	1
pin	1332 668	1
spring	1332 669	1
levering-in device (group #1)	dwg.23a3896	1
latch checking switch	1533 982	1
rectox rectifier	1491 499 ==	1
rectox unit	1116 690	1
resistor - 2 ohm	389 076	1

== not part of complete breaker style number

note: Parts indented are included in the part under which they are indented. Order part by name and identification number - give complete nameplate reading.

supersedes issue dated August, 1950

effective August, 1953

www.ElectricalPartManuals.com



type 50-DH-150-A "De-ion" air circuit breaker
 electrically operated - drawout mounting
 2000 ampere - 4.16 kv. - 60 cycle - 3 pole

renew
 parts d

style no. 1574 384

the following parts are most subject to wear in ordinary operation:

name of part	identification number	num per a
breaker complete	1574 384	1
breaker unit (page ACB-50DH150A-30)	1572 451	1
arc chamber	1370 466	3
arc chamber to stationary contact shunt	1444 857	3
cross bar	1533 976	1
operating rod	1533 942	3
operating mechanism (page CBM-4)	1648 091	1
closing coil - 230 volt a-c	676 629	1
main barrier	1446 172	1
blowout barrier	1444 845	3
mechanism panel	1448 368	1
solenoid cutoff switch	1418 855	1
operation counter	942 801	1
operation counter link	1448 350	1
shunt trip attachment	1533 981	1
shunt trip coil - 230 volt a-c	478 047	1
type W auxiliary switch - 9 pole (page S-W-A-22)	1481 651	1
primary disconnecting contact	1572 122	6
contact finger	1300 589	90
contact finger spring	1300 592	90
secondary and grounding disconnecting contact (group #1)	dwg.23a3891	1
grounding contact	1166 621	1
secondary contact plug	1241 724	1
pin	1332 668	1
spring	1332 669	1
levering-in device (group #1)	dwg.23a3896	1
undervoltage trip	1584 808	1
compression spring	1584 401	1
torsion spring	1589 394	1
coil for above	1019 285	1
undervoltage time delay device	1087 206	1
transformer - 550 volt	1091 238	1
rectox unit	971 430	3
capacitor - 37.5 mfd.	1446 426	1
resistor - 5000 ohm	1250 335	3
resistor - 25000 ohm (Ohmite Brown Devil 10 watt)	...	1
rectox rectifier	1491 499 ==	1
rectox unit	1116 690	1
resistor - 2 ohm	389 076	1

note: Parts indented are included in the part under which they are indented. Order part by name and identification number - give complete nameplate reading.

== not part of complete breaker style number

supersedes issue dated May, 1952

effective August, 1953

www.ElectricalPartManuals.com



type 50-DH-150-A "De-ion" air circuit breaker
 electrically operated - drawout mounting
 2000 ampere - 4.16 kv. - 60 cycle - 3 pole

renewal
 parts da

style no. 1574 385

the following parts are most subject to wear in ordinary operation:

name of part	identification number	numb per u
breaker complete	1574 385	1
breaker unit (page ACB-50DH150A-30)	1572 451	1
arc chamber	1370 466	3
arc chamber to stationary contact shunt	1444 857	3
cross bar	1533 976	1
operating rod	1533 942	3
operating mechanism (page CBM-4)	1648 091	1
closing coil - 230 volt a-c	676 629	1
main barrier	1446 172	1
blowout barrier	1444 845	3
mechanism panel	1448 368	1
solenoid cutoff switch	1418 855	1
operation counter	942 801	1
shunt trip attachment	1533 981	1
shunt trip coil - 230 volt a-c	478 047	1
type W auxiliary switch - 9 pole (page S-W-A-22)	1481 651	1
primary disconnecting contact	1572 122	6
contact finger	1300 589	90
contact finger spring	1300 592	90
secondary and grounding disconnecting contact (group #1)	dwg.23a3891	1
grounding contact	1166 621	1
secondary contact plug	1241 724	1
pin	1332 668	1
spring	1332 669	1
levering-in device (group #1)	dwg.23a3896	1
undervoltage trip	1584 808	1
compression spring	1589 401	1
torsion spring	1589 394	1
coil for above	945 084	1
transformer and rectox	1227 233	1
rectox unit	971 299	1
transformer	1227 527	1
rectox rectifier	1491 499 ==	1
rectox unit	1116 690	1
resistor - 2 ohm	389 076	1

== not part of complete breaker style number

note: Parts indented are included in the part under which they are indented. Order part by name and identification number — give complete nameplate reading.

supersedes issue dated May, 1952

effective August, 1953

www.ElectricalPartManuals.com



type 50-DH-150-A/250/A "De-ion" air circuit breaker
breaker unit

2000 ampere - 4.16 kv. - 3 pole

style no. 1572 451

renewal
parts d

For typical illustration, see r.p.i. 33-670-1, section:breaker unit;facir
the following parts are most subject to wear in ordinary operation: Page ACB-50DH150A
ref. 15

no.	name of part	identification number	numl per u:
..	breaker unit	1572 451	1
1	moving contact complete	...	3
2	contact arm	1221 943	3
3	arcing contact	1346 108	3
4	bolt (item 43)	dwg.17a2707	9
5	main contact - left hand	1221 945	3
5	main contact - right hand	1221 946	3
6	main contact spring	1221 790	12
7	main contact nut	1303 269	12
9	baffle - upper	1370 478	3
10	moving contact arm bearing	1370 485	3
11	hinge pin	885 593	3
12	moving main contact shunt	1370 480	3
13	stationary arcing contact	1392 505	3
14	spring guide	1444 860	3
15	spring - inner	1370 482	3
15	spring - outer	1370 481	3
16	barrier - small	1370 486	3
17	barrier - large	1370 487	3
18	.190-32 x 3/8" flat head machine screw	std.hdw.	6
19	stationary arcing contact guide	1370 476	6
20	stationary arcing contact shunt	1332 654	3
21	shunt spring	1176 795	6
22	shunt screw - rear (item 25)	dwg.17a2707	6
22	shunt screw - front (item 29)	dwg.17a2707	6
23	insulating washer	1091 984	6
24	baffle - lower	1463 234	3
25	main contact with upper stud	1534 776	3
26	main contact with lower stud	1534 777	3

note: Parts indented are included in the part under which they are indented. Order part by name and identification number - give complete nameplate reading.

supersedes issue dated August, 1950

effective May, 1953

www.ElectricalPartManuals.com



type 50-DH-150-D "De-ion" air circuit breaker
 electrically operated - drawout mounting
 600 ampere - 4.16 kv. - 60 cycle - 3 pole

renewal
 parts da

style no. 1649 675

the following parts are most subject to wear in ordinary operation:

name of part	identification number	numb per ur
breaker complete	1649 675	1
breaker unit (page ACB-50DH150D-15)	1648 112	1
arc chamber	1645 279	3
cross bar	1533 975	1
operating rod	1640 746	3
operating mechanism (page CBM-5)	1648 115	1
closing coil - 125 volt d-c	676 629	1
main barrier	1616 235	1
blowout barrier	1370 494	3
mechanism panel	1448 368	1
solenoid cutoff switch	1418 855	1
operation counter	942 801	1
operation counter link	1448 350	1
shunt trip attachment	1533 980	1
shunt trip coil - 125 volt d-c	476 676	1
type W auxiliary switch - 9 pole (page S-W-A-22)	1481 651	1
primary disconnecting contact	1300 586	6
contact finger	1300 590	30
contact finger spring	1300 593	30
ground disconnecting contact (group #1)	dwg.23a3891	1
ground contact	1166 621	1
pin	1332 668	1
spring	1332 669	1
secondary contact plug	1241 724	1
levering-in device (group #1)	dwg.23a3887	1

note: Parts indented are included in the part under which they are indented. Order part by name and identification number — give complete nameplate reading.

effective February, 1953

www.ElectricalPartManuals.com



type 50-DH-150-D "De-ion" air circuit breaker
 electrically operated - drawout mounting
 600 ampere - 4.16 kv. - 60 cycle - 3 pole

renewal
 parts da

style no. 1649 675

the following parts are most subject to wear in ordinary operation:

name of part	identification number	numb per un
breaker complete	1649 675	1
breaker unit (page ACB-50DH150D-15)	1648 112	1
arc chamber	1645 279	3
cross bar	1533 975	1
operating rod	1640 746	3
operating mechanism (page CBM-5)	1648 115	1
closing coil - 125 volt d-c	676 629	1
main barrier	1616 235	1
blowout barrier	1370 494	3
mechanism panel	1448 368	1
solenoid cutoff switch	1418 855	1
operation counter	942 801	1
operation counter link	1448 350	1
shunt trip attachment	1533 980	1
shunt trip coil - 125 volt d-c	476 676	1
type W auxiliary switch - 9 pole (page S-W-A-22)	1481 651	1
primary disconnecting contact	1300 586	6
contact finger	1300 590	30
contact finger spring	1300 593	30
ground disconnecting contact (group #1)	dwg.23a3891	1
ground contact	1166 621	1
pin	1332 668	1
spring	1332 669	1
secondary contact plug	1241 724	1
levering-in device (group #1)	dwg.23a3887	1

note: Parts indented are included in the part under which they are indented. Order part by name and identification number — give complete nameplate reading.

effective February, 1953

www.ElectricalPartManuals.com



type 50-DH-150-D "De-ion" air circuit breaker
 electrically operated - drawout mounting
 600 ampere - 4.16 kv. - 60 cycle - 3 pole

renewal
 parts da

style no. 1649 676

the following parts are most subject to wear in ordinary operation:

name of part	identification number	number per unit
breaker complete	1649 676	1
breaker unit (page ACB-50DH150D-15)	1648 112	1
arc chamber	1645 279	3
cross bar	1533 975	1
operating rod	1640 746	3
operating mechanism (page CBM-5)	1648 115	1
closing coil - 250 volt d-c	676 624	1
main barrier	1616 235	1
blowout barrier	1370 494	3
mechanism panel	1448 368	1
solenoid cutoff switch	1418 855	1
operation counter	942 801	1
operation counter link	1448 350	1
shunt trip attachment	1533 980	1
shunt trip coil - 250 volt d-c	712 266	1
type W auxiliary switch - 9 pole (page S-W-A-22)	1481 651	1
primary disconnecting contact	1300 586	6
contact finger	1300 590	30
contact finger spring	1300 593	30
ground disconnecting contact (group #1)	dwg.23a3891	1
ground contact	1166 621	1
pin	1332 668	1
spring	1332 669	1
secondary contact plug	1241 724	1
levering-in device (group #1)	dwg.23a3887	1

note: Parts indented are included in the part under which they are indented. Order part by name and identification number — give complete nameplate reading.

effective February, 1953

www.ElectricalPartManuals.com



type 50-DH-150-D "De-ion" air circuit breaker
 electrically operated - drawout mounting
 600 ampere - 4.16 kv. - 60 cycle - 3 pole

renewal
 parts da

style no. 1649 677

the following parts are most subject to wear in ordinary operation:

name of part	identification number	numb. per un
breaker complete	1649 677	1
breaker unit (page ACB-50DH150D-15)	1648 112	1
arc chamber	1645 279	3
cross bar	1533 975	1
operating rod	1640 746	3
operating mechanism (page CBM-5)	1648 115	1
operating coil - 230 volt a-c	676 629	1
main barrier	1616 235	1
blowout barrier	1370 494	3
mechanism panel	1448 368	1
solenoid cutoff switch	1418 855	1
operation counter	942 801	1
operation counter link	1448 350	1
shunt trip attachment	1533 981	1
capacitor shunt trip coil	300 870	1
type W auxiliary switch - 9 pole (page S-W-A-22)	1481 651	1
primary disconnecting contact	1300 586	6
contact finger	1300 590	30
contact finger spring	1300 593	30
ground disconnecting contact (group #1)	dwg. 23a3891	1
ground contact	1166 621	1
pin	1332 668	1
spring	1332 669	1
secondary contact plug	1241 724	1
levering-in device (group #1)	dwg. 23a3887	1
capacitor trip device	1254 358	1
rectox unit	1224 936	3
capacitor - 37.5 mfd.	1446 426	2
resistor - 2 megohm	791 850	1
transformer	1224 902	1
lamp receptacle	822 328	1
neon pilot lamp	1174 168	1
lens - clear	822 270	1

note: Parts indented are included in the part under which they are indented. Order part by name and identification number - give complete nameplate reading.

effective February, 1953

www.ElectricalPartManuals.com



type 50-DH-150-D "De-ion" air circuit breaker
 electrically operated - drawout mounting
 600 ampere - 4.16 kv. - 60 cycle - 3 pole

renewal
 parts da

style no. 1649 678

the following parts are most subject to wear in ordinary operation:

name of part	identification number	numb per un
breaker complete	1649 678	1
breaker unit (page ACB-50DH150D-15)	1648 112	1
arc chamber	1645 279	3
cross bar	1533 975	1
operating rod	1640 746	3
operating mechanism (page CBM-5)	1648 115	1
closing coil - 230 volt a-c	676 629	1
main barrier	1616 235	1
blowout barrier	1370 494	3
mechanism panel	1448 368	1
solenoid cutoff switch	1418 855	1
operation counter	942 801	1
operation counter link	1448 350	1
shunt trip attachment	1533 980	1
shunt trip coil - 48 volt d-c	478 047	1
type W auxiliary switch - 9 pole (page S-W-A-22)	1481 651	1
primary disconnecting contact	1300 586	6
contact finger	1300 590	30
contact finger spring	1300 593	30
ground disconnecting contact (group #1)	dwg.23a3891	1
ground contact	1166 621	1
pin	1332 668	1
spring	1332 669	1
secondary contact plug	1241 724	1
levering-in device (group #1)	dwg.23a3887	1

note: Parts indented are included in the part under which they are indented. Order part by name and identification number — give complete nameplate reading.

effective February, 1953

www.ElectricalPartManuals.com



type 50-DH-150-D "De-ion" air circuit breaker
 electrically operated - drawout mounting
 600 ampere - 4.16 kv. - 60 cycle - 3 pole

renewal
 parts d

style no. 1649 679

the following parts are most subject to wear in ordinary operation:

name of part	identification number	number per unit
breaker complete	1649 679	1
breaker unit (page ACB-50DH150D-15)	1648 112	1
arc chamber	1645 279	3
cross bar	1533 975	1
operating rod	1640 746	3
operating mechanism (page CBM-5)	1648 115	1
closing coil - 230 volt a-c	676 629	1
main barrier	1616 235	1
blowout barrier	1370 494	3
mechanism panel	1448 368	1
solenoid cutoff switch	1418 855	1
operation counter	942 801	1
operation counter link	1448 350	1
shunt trip attachment	1533 980	1
shunt trip coil - 24 volt d-c	476 915	1
type W auxiliary switch - 9 pole (page S-W-A-22)	1481 651	1
primary disconnecting contact	1300 586	6
contact finger	1300 590	30
contact finger spring	1300 593	30
ground disconnecting contact (group #1)	dwg.23a3891	1
ground contact	1166 621	1
pin	1332 668	1
spring	1332 669	1
secondary contact plug	1241 724	1
levering-in device (group #1)	dwg.23a3887	1

note: Parts indented are included in the part under which they are indented. Order part by name and identification number — give complete nameplate reading.

effective February, 1953

www.ElectricalPartManuals.com



type 50-DH-150-D "De-ion" air circuit breaker
 electrically operated - drawout mounting
 600 ampere - 4.16 kv. - 60 cycle - 3 pole

renewal
 parts da

style no. 1649 680

the following parts are most subject to wear in ordinary operation:

name of part	identification number	numb per ur
breaker complete	1649 680	1
breaker unit (page ACB-50DH150D-15)	1648 112	1
arc chamber	1645 279	3
cross bar	1533 975	1
operating rod	1640 746	3
operating mechanism (page CBM-5)	1648 115	1
closing coil - 230 volt - 230 volt a-c	676 629	1
main barrier	1616 235	1
blowout barrier	1370 494	3
mechanism panel	1448 368	1
solenoid cutoff switch	1418 855	1
operation counter	942 801	1
operation counter link	1448 350	1
shunt trip attachment	1533 981	1
shunt trip coil - 230 volt a-c	478 047	1
type W auxiliary switch - 9 pole (page S-W-A-22)	1481 651	1
primary disconnecting contact	1300 586	6
contact finger	1300 590	30
contact finger spring	1300 593	30
ground disconnecting contact (group #1)	dwg.23a3891	1
ground contact	1166 621	1
pin	1332 668	1
spring	1332 669	1
secondary contact plug	1241 724	1
levering-in device (group #1)	dwg.23a3887	1

note: Parts indented are included in the part under which they are indented. Order part by name and identification number — give complete nameplate reading.

effective February, 1953

www.ElectricalPartManuals.com



type 50-DH-150-D "De-ion" air circuit breaker
 electrically operated - drawout mounting
 600 ampere - 4.16 kv. - 60 cycle - 3 pole

renewal
 parts d:

style no. 1649 681

the following parts are most subject to wear in ordinary operation:

name of part	identification number	number per unit
breaker complete	1649 681	1
breaker unit (page ACB-50DH150D-15)	1648 112	1
arc chamber	1645 279	3
cross bar	1533 975	1
operating rod	1640 746	3
operating mechanism (page CBM-5)	1648 115	1
closing coil - 125 volt d-c	676 629	1
main barrier	1616 235	1
blowout barrier	1370 494	3
mechanism panel	1448 368	1
solenoid cutoff switch	1418 855	1
operation counter	942 801	1
operation counter link	1448 350	1
shunt trip attachment	1533 980	1
shunt trip coil - 125 volt d-c	476 676	1
type W auxiliary switch - 9 pole (page S-W-A-22)	1481 651	1
primary disconnecting contact	1300 586	6
contact finger	1300 590	30
contact finger spring	1300 593	30
ground disconnecting contact (group #1)	dwg.23a3891	1
ground contact	1166 621	1
pin	1332 668	1
spring	1332 669	1
secondary contact plug	1241 724	1
levering-in device (group #1)	dwg.23a3887	1
latch checking switch	1533 982	1

note: Parts indented are included in the part under which they are indented. Order part by name and identification number — give complete nameplate reading.

effective February, 1953

www.ElectricalPartManuals.com



type 50-DH-150-D "De-ion" air circuit breaker
 electrically operated - drawout mounting
 600 ampere - 4.16 kv. - 60 cycle - 3 pole

renewal
 parts da

style no. 1649 682

the following parts are most subject to wear in ordinary operation:

name of part	identification number	numb per unit
breaker complete	1649 682	1
breaker unit (page ACB-50DH150D-15)	1648 112	1
arc chamber	1645 279	3
cross bar	1533 975	1
operating rod	1640 746	3
operating mechanism (page CBM-5)	1648 115	1
closing coil - 250 volt d-c	676 624	1
main barrier	1616 235	1
blowout barrier	1370 494	3
mechanism panel	1448 368	1
solenoid cutoff switch	1418 855	1
operation counter	942 801	1
operation counter link	1448 350	1
shunt trip attachment	1533 980	1
shunt trip coil - 250 volt d-c	712 266	1
type W auxiliary switch - 9 pole (page S-W-A-22)	1481 651	1
primary disconnecting contact	1300 586	6
contact finger	1300 590	30
contact finger spring	1300 593	30
ground disconnecting contact (group #1)	dwg.23a3891	1
ground contact	1166 621	1
pin	1332 668	1
spring	1332 669	1
secondary contact plug	1241 724	1
levering-in device (group #1)	dwg.23a3887	1
latch checking switch	1533 982	1

note: Parts indented are included in the part under which they are indented. Order part by name and identification number — give complete nameplate reading.

effective February, 1953

www.ElectricalPartManuals.com



type 50-DH-150-D "De-ion" air circuit breaker
 electrically operated - drawout mounting
 600 ampere - 4.16 kv. - 60 cycle - 3 pole

renewal
 parts da

style no. 1649 683

the following parts are most subject to wear in ordinary operation:

name of part	identification number	numb per un
breaker complete	1649 683	1
breaker unit (page ACB-50DH150D-15)	1648 112	1
arc chamber	1645 279	3
cross bar	1533 975	1
operating rod	1640 746	3
operating mechanism (page CBM-5)	1648 115	1
closing coil - 230 volt a-c	676 629	1
main barrier	1616 235	1
blowout barrier	1370 494	3
mechanism panel	1448 368	1
solenoid cutoff switch	1418 855	1
operation counter	942 801	1
operation counter link	1448 350	1
shunt trip attachment	1533 981	1
capacitor shunt trip coil	300 870	1
type W auxiliary switch - 9 pole (page S-W-A-22)	1481 651	1
primary disconnecting contact	1300 586	6
contact finger	1300 590	30
contact finger spring	1300 593	30
ground disconnecting contact (group #1)	dwg.23a3891	1
ground contact	1166 621	1
pin	1332 668	1
spring	1332 669	1
secondary contact plug	1241 724	1
levering-in device (group #1)	dwg.23a3887	1
capacitor trip device	1254 358	1
rectox unit	1224 936	3
capacitor - 37.5 mfd.	1446 426	2
resistor - 2 megohm	791 850	1
transformer	1224 902	1
lamp receptacle	822 328	1
neon pilot lamp	1174 168	1
lens - clear	822 270	1
latch checking switch	1533 982	1

note: Parts indented are included in the part under which they are indented. Order part by name and identification number — give complete nameplate reading.

effective February, 1953

www.ElectricalPartManuals.com



type 50-DH-150-D "De-ion" air circuit breaker
 electrically operated - drawout mounting
 600 ampere - 4.16 kv. - 60 cycle - 3 pole

renewal
 parts da

style no. 1649 684

the following parts are most subject to wear in ordinary operation:

name of part	identification number	numb per ur
breaker complete	1649 684	1
breaker unit (page ACB-50DH150D-15)	1648 112	1
arc chamber	1645 279	3
cross bar	1533 975	1
operating rod	1640 746	3
operating mechanism (page CBM-5)	1648 115	1
closing coil - 230 volt a-c	676 629	1
main barrier	1616 235	1
blowout barrier	1370 494	3
mechanism panel	1448 368	1
solenoid cutoff switch	1418 855	1
operation counter	942 801	1
operation counter link	1448 350	1
shunt trip attachment	1533 980	1
shunt trip coil - 48 volt d-c	478 047	1
type W auxiliary switch - 9 pole (page S-W-A-22)	1481 651	1
primary disconnecting contact	1300 586	6
contact finger	1300 590	30
contact finger spring	1300 593	30
ground disconnecting contact (group #1)	dwg.23a3891	1
ground contact	1166 621	1
pin	1332 668	1
spring	1332 669	1
secondary contact plug	1241 724	1
levering-in device (group #1)	dwg.23a3887	1
latch checking switch	1533 982	1

note: Parts indented are included in the part under which they are indented. Order part by name and identification number — give complete nameplate reading.

effective February, 1953

www.ElectricalPartManuals.com



type 50-DH-150-D "De-ion" air circuit breaker
 electrically operated - drawout mounting
 600 ampere - 4.16 kv. - 60 cycle - 3 pole

renewal
 parts da

style no. 1649 685

the following parts are most subject to wear in ordinary operation:

name of part	identification number	numb. per un
breaker complete	1649 685	1
breaker unit (page ACB-50DH150D-15)	1648 112	1
arc chamber	1645 279	3
cross bar	1533 975	1
operating rod	1640 746	3
operating mechanism (page CBM-5)	1648 115	1
closing coil - 230 volt a-c	676 629	1
main barrier	1616 235	1
blowout barrier	1370 494	3
mechanism panel	1448 368	1
solenoid cutoff switch	1418 855	1
operation counter	942 801	1
operation counter link	1448 350	1
shunt trip attachment	1533 980	1
shunt trip coil - 24 volt d-c	476 915	1
type W auxiliary switch - 9 pole (page S-W-A-22)	1481 651	1
primary disconnecting contact	1300 586	6
contact finger	1300 590	30
contact finger spring	1300 593	30
ground disconnecting contact (group #1)	dwg. 23a3891	1
ground contact	1166 621	1
pin	1332 668	1
spring	1332 669	1
secondary contact plug	1241 724	1
levering-in device (group #1)	dwg. 23a3887	1
latch checking switch	1533 982	1

note: Parts indented are included in the part under which they are indented. Order part by name and identification number — give complete nameplate reading.

effective February, 1953

www.ElectricalPartManuals.com



type 50-DH-150-D "De-ion" air circuit breaker
 electrically operated - drawout mounting
 600 ampere - 4.16 kv. - 60 cycle - 3 pole

renewal
 parts list

style no. 1649 686

the following parts are most subject to wear in ordinary operation:

name of part	identification number	number per unit
breaker complete	1649 686	1
breaker unit (page ACB-50DH150D-15)	1648 112	1
arc chamber	1645 279	3
cross bar	1533 975	1
operating rod	1640 746	3
operating mechanism (page CBM-5)	1648 115	1
closing coil - 230 volt a-c	676 629	1
main barrier	1616 235	1
blowout barrier	1370 494	3
mechanism panel	1448 368	1
solenoid cutoff switch	1418 855	1
operation counter	942 801	1
operation counter link	1448 350	1
shunt trip attachment	1533 981	1
shunt trip - 230 volt a-c	478 047	1
type W auxiliary switch - 9 pole (page S-W-A-22)	1481 651	1
primary disconnecting contact	1300 586	6
contact finger	1300 590	30
contact finger spring	1300 593	30
ground disconnecting contact (group #1)	dwg.23a3891	1
ground contact	1166 621	1
pin	1332 668	1
spring	1332 669	1
secondary contact plug	1241 724	1
levering-in device (group #1)	dwg.23a3887	1
latch checking switch	1533 982	1

note: Parts indented are included in the part under which they are indented. Order part by name and identification number — give complete nameplate reading.

effective February, 1953

www.ElectricalPartManuals.com



type 50-DH-150-D "De-ion" air circuit breaker
 electrically operated - drawout mounting
 600 ampere - 4.16 kv. - 60 cycle - 3 pole

renewal
 parts da

style no. 1649 687

the following parts are most subject to wear in ordinary operation:

name of part	identification number	numb per un
breaker complete	1649 687	1
breaker unit (page ACB-50DH150D-15)	1648 112	1
arc chamber	1645 279	3
cross bar	1533 975	1
operating rod	1640 746	3
operating mechanism (page CBM-5)	1648 115	1
closing coil - 230 volt a-c	676 629	1
main barrier	1616 235	1
blowout barrier	1370 494	3
mechanism panel	1448 368	1
solenoid cutoff switch	1418 855	1
operation counter	942 801	1
operation counter link	1448 350	1
shunt trip attachment	1533 981	1
shunt trip coil - 230 volt a-c	478 047	1
type W auxiliary switch - 9 pole (page S-W-A-22)	1481 651	1
primary disconnecting contact	1300 586	6
contact finger	1300 590	30
contact finger spring	1300 593	30
ground disconnecting contact (group #1)	dwg.23a3891	1
ground contact	1166 621	1
pin	1332 668	1
spring	1332 669	1
secondary contact plug	1241 724	1
levering-in device (group #1)	dwg.23a3887	1
undervoltage trip	1584 808	1
compression spring	1584 401	1
torsion spring	1589 394	1
coil for above	1019 285	1
undervoltage time delay device	1087 206	1
transformer - 550 volt	1091 238	1
rectox unit	971 430	3
capacitor - 37.5 mfd.	1446 426	1
resistor - 5000 ohm	1250 335	3
resistor - 25000 ohm (Ohmite Brown Devil 10 watt)	...	1

note: Parts indented are included in the part under which they are indented. Order part by name and identification number — give complete nameplate reading.

effective February, 1953

www.ElectricalPartManuals.com



type 50-DH-150-D "De-ion" air circuit breaker
 electrically operated - drawout mounting
 600 ampere - 4.16 kv. - 60 cycle - 3 pole

renewal
 parts d

style no. 1649 688

the following parts are most subject to wear in ordinary operation:

name of part	identification number	quantity per unit
breaker complete	1649 688	1
breaker unit (page ACB-50DH150D-15)	1648 112	1
arc chamber	1645 279	3
cross bar	1533 975	1
operating rod	1640 746	3
operating mechanism (page CBM-5)	1648 115	1
closing coil - 230 volt a-c	676 629	1
main barrier	1616 235	1
blowout barrier	1370 494	3
mechanism panel	1448 368	1
solenoid cutoff switch	1418 855	1
operation counter	942 801	1
operation counter link	1448 350	1
shunt trip attachment	1533 981	1
shunt trip coil - 230 volt a-c	478 047	1
type W auxiliary switch - 9 pole (page S-W-A-22)	1481 651	1
primary disconnecting contact	1300 586	6
contact finger	1300 590	30
contact finger spring	1300 593	30
ground disconnecting contact (group #1)	dwg.23a3891	1
ground contact	1166 621	1
pin	1332 668	1
spring	1332 669	1
secondary contact plug (group #1)	1251 724	1
levering-in device (group #1)	dwg.23a3887	1
undervoltage trip	1584 808	1
compression spring	1589 401	1
torsion spring	1589 394	1
coil for above	945 084	1
transformer and rectox	1227 233	1
rectox unit	971 299	1
transformer	1227 527	1

note: Parts indented are included in the part under which they are indented. Order part by name and identification number — give complete nameplate reading.

effective February, 1953

www.ElectricalPartManuals.com

renewal parts
illustration
33-670-2
section
breaker unit

air circuit breaker
type DH
three pole breaker unit



switchgear apparatus

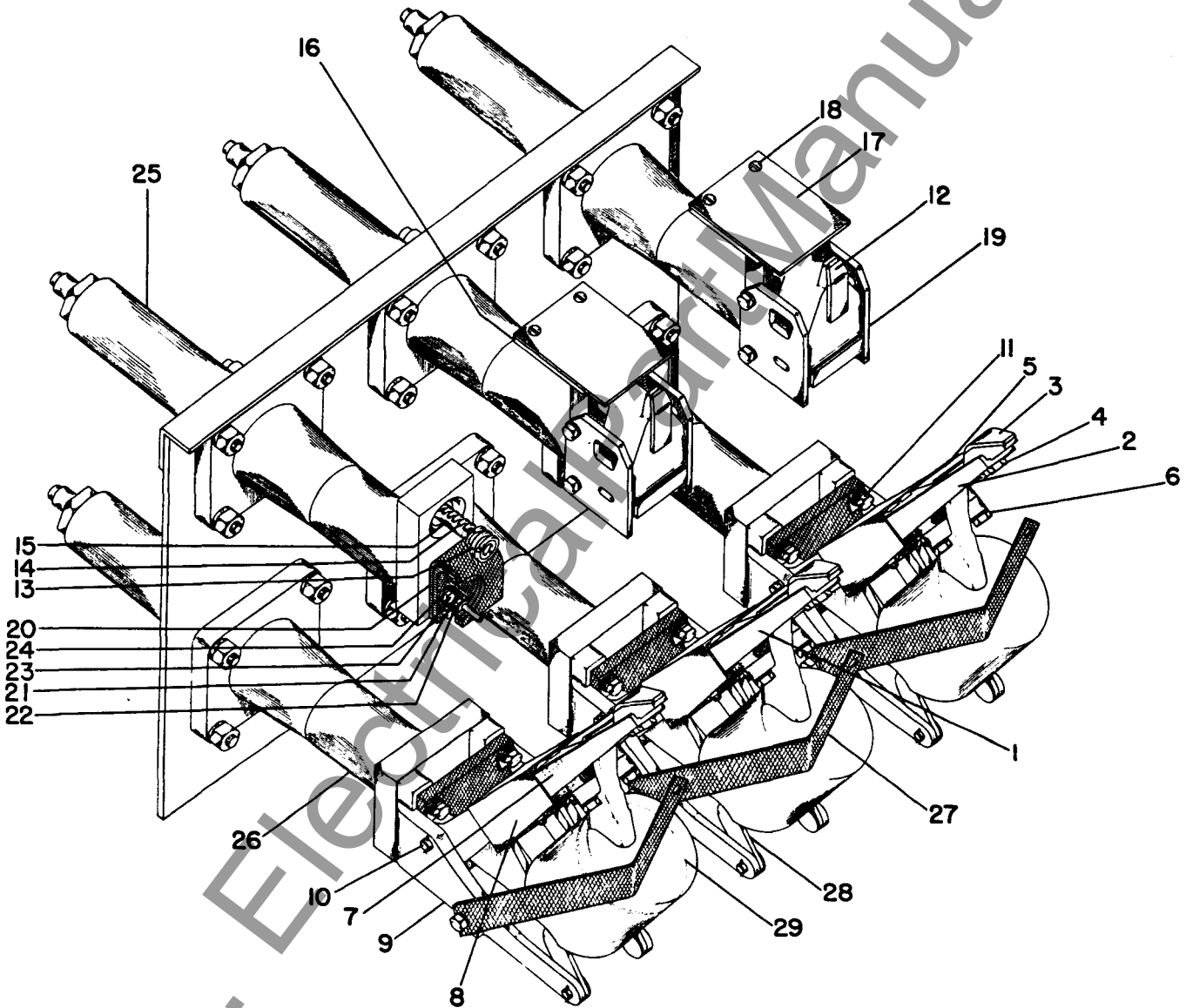

effective August, 1952

www.ElectricalPartManuals.com



switchgear apparatus
 type 50-DH-150-D "De-ion" air circuit breaker
 breaker unit
 600 ampere - 4.16 kv. - 3 pole
 style no. 1648 112

renewal
 parts data
 33-670
 section
 DH
 1648112

For typical illustration, see r.p.i. 33-670-2, section: breaker unit; facing
 the following parts are most subject to wear in ordinary operation: page ACB-50DH150D
 ref.

no.	name of part	identification number	15	number per unit
..	breaker unit	1648 112		1
1	moving contact complete	dwg. 39a8759		3
2	contact arm	1645 313		3
3	arcing contact	1645 128		3
4	arcing contact bolt (item 41)	dwg. 39a8759		6
5	main and secondary contact with shunt	1645 130		3
6	main contact bolt - upper (item 44)	dwg. 39a8759		6
7	main contact bolt - lower (item 50)	dwg. 39a8759		3
8	contact arm insulation	1645 255		3
9	bearing bracket	1645 132		3
10	hinge pin	1627 784		3
11	bolt to attach shunt (item 51)	dwg. 39a8759		6
12	stationary arcing and secondary contact	1645 338		3
13	stationary contact spring - outer	1645 122		3
14	stationary contact spring - inner	1645 123		3
15	spring guide	1370 484		3
16	barrier - lower	1370 486		3
17	barrier - upper	1370 487		3
18	.190-32 x 3/8" flat head steel screw	std. hdw.		6
19	contact guide	1645 337		6
20	stationary contact shunt	1645 253		3
21	shunt spring	1718 019		6
22	nut to attach shunt (item 23)	dwg. 39a8759		6
23	bolt to attach shunt (item 22)	dwg. 39a8759		6
24	insulating washer	1091 984		6
25	stationary main contact with upper stud	1649 598		3
26	stationary main contact with lower stud	1649 599		3
27	shunt from arc chamber to lower stud	1640 744		3
28	puffer piston	1616 220		3
29	felt disc	1616 223		6

note: Parts indented are included in the part under which they are indented. Order part by name and identification number — give complete nameplate reading.

supersedes issue dated July, 1952

effective August, 1953

www.ElectricalPartManuals.com



type 50-DH-150-D "De-ion" air circuit breaker
 electrically operated - drawout mounting
 1200 ampere - 4.16 kv. - 60 cycle - 3 pole

renewal
 parts da

style no. 1640 158

the following parts are most subject to wear in ordinary operation:

name of part	identification number	numb per un
breaker complete	1640 158	1
breaker unit (page ACB-50DH150D-30)	1736 703	1
arc chamber	1645 279	3
cross bar	1533 975	1
operating rod	1640 746	3
operating mechanism (page CBM-5)	1648 115	1
closing coil - 125 volt d-c	676 629	1
main barrier	1616 235	1
blowout barrier	1370 495	3
mechanism panel	1448 368	1
solenoid cutoff switch	1418 855	1
operation counter	942 801	1
operation counter link	1448 350	1
shunt trip attachment	1533 980	1
shunt trip coil - 125 volt d-c	476 676	1
type W auxiliary switch - 9 pole (page S-W-A-22)	1481 651	1
primary disconnecting contact	1300 587	6
contact finger	1300 591	54
contact finger spring	1300 594	54
ground disconnecting contact (group #1)	dwg.23a3891	1
ground contact	1166 621	1
pin	1332 668	1
spring	1332 669	1
secondary contact plug	1241 724	1
levering-in device (group #1)	dwg.23a3887	1

note: Parts indented are included in the part under which they are indented. Order part by name and identification number — give complete nameplate reading.

supersedes issue dated October, 1952

effective February, 1953

www.ElectricalPartManuals.com



type 50-DH-150-D "De-ion" air circuit breaker
 electrically operated - drawout mounting
 1200 ampere - 4.16 kv. - 60 cycle - 3 pole

renewal
 parts da

style no. 1640 159

the following parts are most subject to wear in ordinary operation:

name of part	identification number	numb. per un
breaker complete	1640 159	1
breaker unit (page ACB-50DH150D-30)	1736 703	1
arc chamber	1645 279	3
cross bar	1533 975	1
operating rod	1640 746	3
operating mechanism (page CBM-5)	1648 115	1
closing coil - 250 volt d-c	676 624	1
main barrier	1616 235	1
blowout barrier	1370 495	3
mechanism panel	1448 368	1
solenoid cutoff switch	1418 855	1
operation counter	942 801	1
operation counter link	1448 350	1
shunt trip attachment	1533 980	1
shunt trip coil - 250 volt d-c	712 266	1
type W auxiliary switch - 9 pole (page S-W-A-22)	1481 651	1
primary disconnecting contact	1300 587	6
contact finger	1300 591	54
contact finger spring	1300 594	54
ground disconnecting contact (group #1)	dwg.23a3891	1
ground contact	1166 621	1
pin	1332 668	1
spring	1332 669	1
secondary contact plug	1241 724	1
levering-in device (group #1)	dwg.23a3887	1

note: Parts indented are included in the part under which they are indented. Order part by name and identification number—give complete nameplate reading.

supersedes issue dated October, 1952

effective February, 1953

www.ElectricalPartManuals.com



type 50-DH-150-D "De-ion" air circuit breaker
 electrically operated - drawout mounting
 1200 ampere - 4.16 kv. - 60 cycle - 3 pole

renewal
 parts da

style no. 1640 160

the following parts are most subject to wear in ordinary operation:

name of part	identification number	numb per uc
breaker complete	1640 160	1
breaker unit (page ACB-50DH150D-30)	1736 703	1
arc chamber	1645 279	3
cross bar	1533 975	1
operating rod	1640 746	3
operating mechanism (page CBM-5)	1648 115	1
operating coil - 230 volt a-c	676 629	1
main barrier	1616 235	1
blowout barrier	1370 495	3
mechanism panel	1448 368	1
solenoid cutoff switch	1418 855	1
operation counter	942 801	1
operation counter link	1448 350	1
shunt trip attachment	1533 981	1
capacitor shunt trip coil	300 870	1
type W auxiliary switch - 9 pole (page S-W-A-22)	1481 651	1
primary disconnecting contact	1300 587	6
contact finger	1300 591	54
contact finger spring	1300 594	54
ground disconnecting contact (group #1)	dwg. 23a3891	1
ground contact	1166 621	1
pin	1332 668	1
spring	1332 669	1
secondary contact plug	1241 724	1
levering-in device (group #1)	dwg 23a3887	1
capacitor trip device	1254 358	1
rectox unit	1224 936	3
capacitor - 37.5 mfd.	1446 426	2
resistor - 2 megohm	791 850	1
transformer	1224 902	1
lamp receptacle	822 328	1
neon pilot lamp	1174 168	1
clear lens	822 270	1

note: Parts indented are included in the part under which they are indented. Order part by name and identification number — give complete nameplate reading.

supersedes issue dated October, 1952

effective February, 1953

www.ElectricalPartManuals.com



type 50-DH-150-D "De-ion" air circuit breaker
 electrically operated - drawout mounting
 1200 ampere - 4.16 kv. - 60 cycle - 3 pole

renewal
 parts da

style no. 1640 161

the following parts are most subject to wear in ordinary operation:

name of part	identification number	number per unit
breaker complete	1640 161	1
breaker unit (page ACB-50DH150D-30)	1736 703	1
arc chamber	1645 279	3
cross bar	1533 975	1
operating rod	1640 746	3
operating mechanism (page CBM-5)	1648 115	1
closing coil - 230 volt a-c	676 629	1
main barrier	1616 235	1
blowout barrier	1370 495	3
mechanism panel	1448 368	1
solenoid cutoff switch	1418 855	1
operation counter	942 801	1
operation counter link	1448 350	1
shunt trip attachment	1533 980	1
shunt trip coil - 48 volt d-c	478 047	1
type W auxiliary switch - 9 pole (page S-W-A-22)	1481 651	1
primary disconnecting contact	1300 587	6
contact finger	1300 591	54
contact finger spring	1300 594	54
ground disconnecting contact (group #1)	dwg.23a3891	1
ground contact	1166 621	1
pin	1332 668	1
spring	1332 669	1
secondary contact plug	1241 724	1
levering-in device (group #1)	dwg.23a3887	1

note: Parts indented are included in the part under which they are indented. Order part by name and identification number — give complete nameplate reading.

supersedes issue dated October, 1952

effective February, 1953

www.ElectricalPartManuals.com



type 50-DH-150D "De-ion" air circuit breaker
 electrically operated - drawout mounting
 1200 ampere - 4.16 kv. - 60 cycle - 3 pole

renewal
 parts d

style no. 1640 162

the following parts are most subject to wear in ordinary operation:

name of part	identification number	quantity per unit
breaker complete	1640 162	1
breaker unit (page ACB-50DH150D-30)	1736 703	1
arc chamber	1645 279	3
cross bar	1533 975	1
operating rod	1640 746	3
operating mechanism (page CBM-5)	1648 115	1
closing coil - 230 volt a-c	676 629	1
main barrier	1616 235	1
blowout barrier	1370 495	3
mechanism panel	1448 368	1
solenoid cutoff switch	1418 855	1
operation counter	942 801	1
operation counter link	1448 350	1
shunt trip attachment	1533 980	1
shunt trip coil - 240 volt d-c	476 915	1
type W auxiliary switch - 9 pole (page S-W-A-22)	1481 651	1
primary disconnecting contact	1300 587	6
contact finger	1300 591	54
contact finger spring	1300 594	54
ground disconnecting contact (group #1)	dwg.23a3891	1
ground contact	1166 621	1
pin	1332 668	1
spring	1332 669	1
secondary contact plug	1241 724	1
levering-in device (group #1)	dwg.23a3887	1

note: Parts indented are included in the part under which they are indented. Order part by name and identification number - give complete nameplate reading.

supersedes issue dated October 1952

effective February, 1953

www.ElectricalPartManuals.com



type 50-DH-150-D "De-ion" air circuit breaker
 electrically operated - drawout mounting
 1200 ampere - 4.16 kv. - 60 cycle - 3 pole

renewal
 parts data

style no. 1640 163

the following parts are most subject to wear in ordinary operation:

name of part	identification number	number per unit
breaker complete	1640 163	1
breaker unit (page ACE 50DH150D-30)	1736 703	1
arc chamber	1645 279	3
cross bar	1533 975	1
operating rod	1640 746	3
operating mechanism (page CEM-5)	1648 115	1
closing coil - 230 volt a-c	676 629	1
main barrier	1616 235	1
blowout barrier	1370 495	3
mechanism panel	1448 368	1
solenoid cutoff switch	1418 855	1
operation counter	942 801	1
operation counter link	1448 350	1
shunt trip attachment	1533 981	1
shunt trip coil - 230 volt a-c	478 047	1
type W auxiliary switch - 9 pole (page S-W-A-22)	1481 651	1
primary disconnecting contact	1300 587	6
contact finger	1300 591	54
contact finger spring	1300 594	54
ground disconnecting contact (group #1)	dwg.23a3891	1
ground contact	1166 621	1
pin	1332 668	1
spring	1332 669	1
secondary contact plug	1241 724	1
levering-in device (group #1)	dwg.23a3887	1

note: Parts indented are included in the part under which they are indented. Order part by name and identification number — give complete nameplate reading.

supersedes issue dated October, 1952

effective February, 1953

www.ElectricalPartManuals.com



type 50-DH-150-D "De-ion" air circuit breaker
 electrically operated - drawout mounting
 1200 ampere - 4.16 kv. - 60 cycle - 3 pole

renewal
 parts data

style no. 1640 164

the following parts are most subject to wear in ordinary operation:

name of part	identification number	number per unit
breaker complete	1640 164	1
breaker unit (page ACB-50DH150D-30)	1736 703	1
arc chamber	1645 279	3
cross bar	1533 975	1
operating rod	1640 746	3
operating mechanism (page CBM-5)	1648 115	1
closing coil - 125 volt d-c	676 629	1
main barrier	1616 235	1
blowout barrier	1370 495	3
mechanism panel	1448 368	1
solenoid cutoff switch	1418 855	1
operation counter	942 801	1
operation counter link	1448 350	1
shunt trip attachment	1533 980	1
shunt trip coil - 125 volt d-c	476 676	1
type W auxiliary switch - 9 pole (page S-W-A-22)	1481 651	1
primary disconnecting contact	1300 587	6
contact finger	1300 591	54
contact finger spring	1300 594	54
ground disconnecting contact (group #1)	dwg.23a3891	1
ground contact	1166 621	1
pin	1332 668	1
spring	1332 669	1
secondary contact plug	1241 724	1
levering-in device (group #1)	dwg.23a3887	1
latch checking switch	1533 982	1

note: Parts indented are included in the part under which they are indented. Order part by name and identification number — give complete nameplate reading.

supersedes issue dated October, 1952

effective February, 1953

www.ElectricalPartManuals.com



type 50-DH-150-D "De-ion" air circuit breaker
 electrically operated - drawout mounting
 1200 ampere - 4.16 kv. - 60 cycle - 3 pole

renewal
 parts data

style no. 1640 165

the following parts are most subject to wear in ordinary operation:

name of part	identification number	number per unit
breaker complete	1640 165	1
breaker unit (page ACB-50DH150D-30)	1736 703	1
arc chamber	1645 279	3
cross bar	1533 975	1
operating rod	1640 746	3
operating mechanism (page CBM-5)	1648 115	1
closing coil - 250 volt d-c	676 624	1
main barrier	1616 235	1
blowout barrier	1370 495	3
mechanism panel	1448 368	1
solenoid cutoff switch	1418 855	1
operation counter	942 801	1
operation counter link	1448 350	1
shunt trip attachment	1533 980	1
shunt trip coil - 250 volt d-c	712 266	1
type W auxiliary switch - 9 pole (page S-W-A-22)	1481 651	1
primary disconnecting contact	1300 587	6
contact finger	1300 591	54
contact finger spring	1300 594	54
ground disconnecting contact (group #1)	dwg. 23a3891	1
ground contact	1166 621	1
pin	1332 668	1
spring	1332 669	1
secondary contact plug	1241 724	1
levering-in device (group #1)	dwg. 23a3887	1
latch checking switch	1533 982	1

note: Parts indented are included in the part under which they are indented. Order part by name and identification number - give complete nameplate reading.

supersedes issue dated October, 1952

effective February, 1953

www.ElectricalPartManuals.com



type 50-DH-150-D "De-ion" air circuit breaker
 electrically operated - drawout mounting
 1200 ampere - 4.16 kv. - 60 cycle - 3 pole

renewal
 parts data

style no. 1640 166

the following parts are most subject to wear in ordinary operation:

name of part	identification number	number per unit
breaker complete	1640 166	1
breaker unit (page ACB-50DH150D-30)	1736 703	1
arc chamber	1645 279	3
cross bar	1533 975	1
operating rod	1640 746	3
operating mechanism (page CBM-5)	1648 115	1
closing coil - 230 volt a-c	676 629	1
main barrier	1616 235	1
blowout barrier	1370 495	3
mechanism panel	1448 368	1
solenoid cutoff switch	1418 855	1
operation counter	942 801	1
operation counter link	1448 350	1
shunt trip attachment	1533 981	1
capacitor shunt trip coil	300 870	1
type W auxiliary switch - 9 pole (page S-W-A-22)	1481 651	1
primary disconnecting contact	1300 587	6
contact finger	1300 591	54
contact finger spring	1300 594	54
ground disconnecting contact (group #1)	dwg.23a3891	1
ground contact	1166 621	1
pin	1332 668	1
spring	1332 669	1
secondary contact plug	1241 724	1
levering-in device (group #1)	dwg.23a3887	1
capacitor trip device	1254 358	1
rectox unit	1224 936	3
capacitor - 37.5 mfd.	1446 426	2
resistor - 2 megohm	791 850	1
transformer	1224 902	1
lamp receptacle	822 328	1
neon pilot lamp	1174 168	1
clear lens	822 270	1
latch checking switch	1533 982	1

note: Parts indented are included in the part under which they are indented. Order part by name and identification number - give complete nameplate reading.

supersedes issue dated October, 1952

effective February, 1953

www.ElectricalPartManuals.com



type 50-DH-150-D "De-ion" air circuit breaker
 electrically operated - drawout mounting
 1200 ampere - 4.16 kv. - 60 cycle - 3 pole

renewal
 parts data

style no. 1640 167

the following parts are most subject to wear in ordinary operation:

name of part	identification number	number per unit
breaker complete	1640 167	1
breaker unit (page ACB-50DH150D-30)	1736 703	1
arc chamber	1645 279	3
cross bar	1533 975	1
operating rod	1640 746	3
operating mechanism (page CBM-5)	1648 115	1
closing coil - 230 volt a-c	676 629	1
main barrier	1616 235	1
blowout barrier	1370 495	3
mechanism panel	1448 368	1
solenoid cutoff switch	1418 855	1
operation counter	942 801	1
operation counter link	1448 350	1
shunt trip attachment	1533 980	1
shunt trip coil - 48 volt d-c	478 047	1
type W auxiliary switch - 9 pole (page S-W-A-22)	1481 651	1
primary disconnecting contact	1300 587	6
contact finger	1300 591	54
contact finger spring	1300 594	54
ground disconnecting contact (group #1)	dwg.23a3891	1
ground contact	1166 621	1
pin	1332 668	1
spring	1332 669	1
secondary contact plug	1241 724	1
levering-in device (group #1)	dwg.23a3887	1
latch checking switch	1533 982	1

note: Parts indented are included in the part under which they are indented. Order part by name and identification number — give complete nameplate reading.

supersedes issue dated October, 1952

effective February, 1953

www.ElectricalPartManuals.com



type 50-DH-150-D "De-ion" air circuit breaker
 electrically operated - drawout mounting
 1200 ampere - 4.16 kv. - 60 cycle - 3 pole

renewal
 parts data

style no. 1640 168

the following parts are most subject to wear in ordinary operation:

name of part	identification number	number per unit
breaker complete	1640 168	1
breaker unit (page ACB-50DH150D-30)	1736 703	1
arc chamber	1645 279	3
cross bar	1533 975	1
operating rod	1640 746	3
operating mechanism (page CBM-5)	1648 115	1
closing coil - 230 volt a-c	676 629	1
main barrier	1616 235	1
blowout barrier	1370 495	3
mechanism panel	1448 368	1
solenoid cutoff switch	1418 855	1
operation counter	942 801	1
operation counter link	1448 350	1
shunt trip attachment	1533 980	1
shunt trip coil - 24 volt d-c	476 915	1
type W auxiliary switch - 9 pole (page S-W-A-22)	1481 651	1
primary disconnecting contact	1300 587	6
contact finger	1300 591	54
contact finger spring	1300 594	54
ground disconnecting contact (group #1)	dwg.23a3891	1
ground contact	1166 621	1
pin	1332 668	1
spring	1332 669	1
secondary contact plug	1241 724	1
levering-in device (group #1)	dwg.23a3887	1
latch checking switch	1533 982	1

note: Parts indented are included in the part under which they are indented. Order part by name and identification number — give complete nameplate reading.

supersedes issue dated October, 1952

effective February, 1953

www.ElectricalPartManuals.com



type 50-DH-150-D "De-ion" air circuit breaker
 electrically operated - drawout mounting
 1200 ampere - 4.16 kv. - 60 cycle - 3 pole

renewal
 parts data

style no. 1640 169

the following parts are most subject to wear in ordinary operation:

name of part	identification number	number per unit
breaker complete	1640 169	1
breaker unit (page ACB-50DH150D-30)	1736 703	1
arc chamber	1645 279	3
cross bar	1533 975	1
operating rod	1640 746	3
operating mechanism (page CBM-5)	1648 115	1
closing coil - 230 volt - 230 volt a-c	676 629	1
main barrier	1616 235	1
blowout barrier	1370 495	3
mechanism panel	1448 368	1
solenoid cutoff switch	1418 855	1
operation counter	942 801	1
operation counter link	1448 350	1
shunt trip attachment	1533 981	1
shunt trip - 230 volt a-c	478 047	1
type W auxiliary switch - 9 pole (page S-W-A-22)	1481 651	1
primary disconnecting contact	1300 587	6
contact finger	1300 591	54
contact finger spring	1300 594	54
ground disconnecting contact (group #1)	dwg.23a3891	1
ground contact	1166 621	1
pin	1332 668	1
spring	1332 669	1
secondary contact plug	1241 724	1
levering-in device (group #1)	dwg.23a3887	1
latch checking switch	1533 982	1

note: Parts indented are included in the part under which they are indented. Order part by name and identification number - give complete nameplate reading.

supersedes issue dated October, 1952

effective February, 1953

www.ElectricalPartManuals.com



type 50-DH-150-D "De-ion" air circuit breaker
 electrically operated - drawout mounting
 1200 ampere - 4.16 kv. - 60 cycle - 3 pole

renewal
 parts data

style no. 1640 170

the following parts are most subject to wear in ordinary operation:

name of part	identification number	number per unit
breaker complete	1640 170	1
breaker unit (page ACB-50DH150D-30)	1736 703	1
arc chamber	1645 279	3
cross bar	1533 975	1
operating rod	1640 746	3
operating mechanism (page CBM-5)	1648 115	1
closing coil - 230 volt a-c	676 629	1
main barrier	1616 235	1
blowout barrier	1370 495	3
mechanism panel	1448 368	1
solenoid cutoff switch	1418 855	1
operation counter	942 801	1
operation counter link	1448 350	1
shunt trip attachment	1533 981	1
shunt trip coil - 230 volt a-c	478 047	1
type W auxiliary switch - 9 pole (page S-W-A-22)	1481 651	1
primary disconnecting contact	1300 587	6
contact finger	1300 591	54
contact finger spring	1300 594	54
ground disconnecting contact (group #1)	dwg.23a3891	1
ground contact	1166 621	1
pin	1332 668	1
spring	1332 669	1
secondary contact plug	1241 724	1
levering-in device (group #1)	dwg.23a3887	1
undervoltage trip	1584 808	1
compression spring	1584 401	1
torsion spring	1589 394	1
coil for above	1019 285	1
undervoltage time delay device	1087 206	1
transformer - 550 volt	1091 238	1
rectox unit	971 430	3
capacitor - 37.5 mfd.	1446 426	1
resistor - 5000 ohm	1250 335	3
resistor - 25000 ohm (Ohmite Brown Devil 10 watt)	...	1

note: Parts indented are included in the part under which they are indented. Order part by name and identification number - give complete nameplate reading.

supersedes issue dated October, 1952

effective February, 1953

www.ElectricalPartManuals.com