

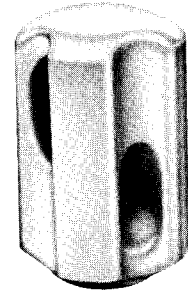

STRAIN INSULATORS

FEATURES

- Purified Porcelain
- Controlled Compression Glaze
- High Mechanical Strength
- Excellent Electrical Characteristics



H-44846A

MECHANICAL, ELECTRICAL VALUES

Cat. No.	USASI Class No.	Tensile Strength Pounds	Low-Frequency Flashover—KV	
			Dry	Wet
502	54-1	10,000	25	12
504	54-2	12,000	30	15
506	54-3	20,000	35	18
556	54-4	20,000	40	23
559	—	33,000	55	28

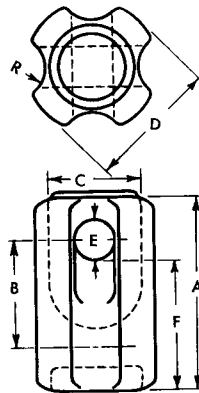

Cat. No. 502
Cat. No. 504
Cat. No. 506

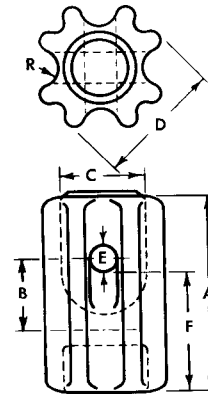

Cat. No. 556
Cat. No. 559

DIMENSIONS, WEIGHTS

Cat. No.	USASI Class No.	DIMENSIONS—Inches										WEIGHT—Pounds		Number in Standard Package
		Leakage Distance	Max. Cable Size	Drawing Reference								Net Per 100	Shipping Per 100	
				A	B	C	D	E	F	R				
502	54-1	1 5/8	3/8	3 1/2	1 3/4	1 3/4	2 1/2	3/8	2 1/2	5/8	94	102	50	
504	54-2	1 7/8	1/2	4 1/4	2 1/4	2 1/8	2 7/8	7/8	3	1 1/8	146	154	50	
506	54-3	2 1/4	5/8	5 1/2	3 1/8	2 3/8	3 3/8	1	4 1/8	1 3/8	256	272	25	
556	54-4	3	5/8	6 3/4	2 3/8	2 3/8	3 3/4	1	4 1/2	3/8	375	395	20	
559	—	3 3/8	3/8	6 3/4	2 3/8	2 3/8	4 7/8	1	4 3/8	5/8	465	500	12	

FOR SELECTION AND APPLICATION INFORMATION—See Section 12.0.3.



SPOOL INSULATORS

FEATURES

- Purified Porcelain
- Controlled Compression Glaze
- High Mechanical Strength
- Excellent Electrical Characteristics

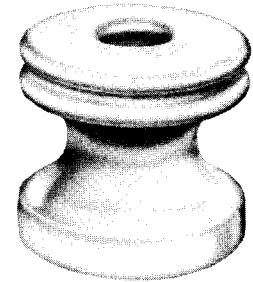

H-44847A

MECHANICAL, ELECTRICAL VALUES

Cat. No.	USASI Class No.	Transverse Strength Pounds	Low-Frequency Flashover—KV		
			Dry	Wet	
				Vertical	Horizontal
2011	53-1	2000	20	8	10
2012	53-2	3000	25	12	15
2013	53-3	4000	25	12	15
2026	53-4	4500	25	12	15
2014	53-5	6000	35	18	25

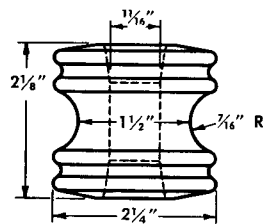

Cat. No. 2011

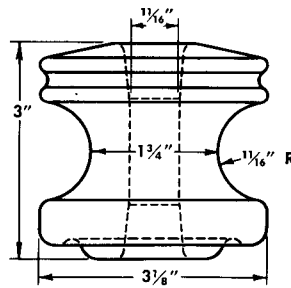

Cat. No. 2012

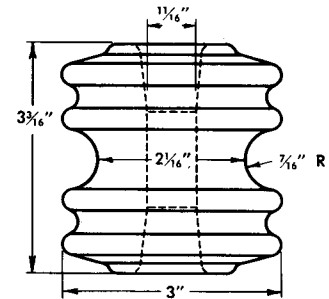

Cat. No. 2013

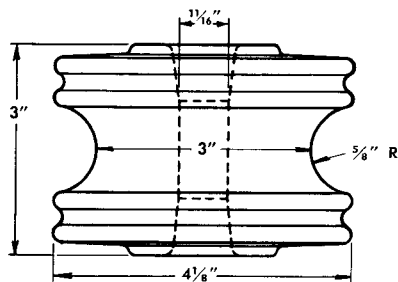

Cat. No. 2026

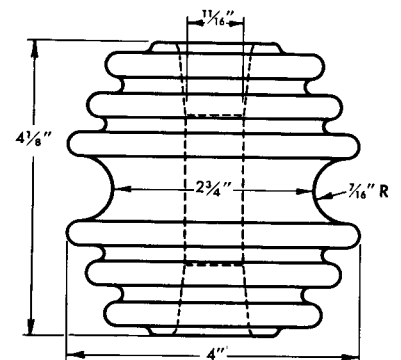

Cat. No. 2014

DIMENSIONS, WEIGHTS

Cat. No.	USASI Class No.	DIMENSIONS—Inches			WEIGHT—Pounds		Number in Standard Package
		Required Opening (Rack or Clevis)	Porcelain		Net Per 100	Shipping Per 100	
			Length	Diameter			
2011	53-1	2 3/8	2 1/8	2 1/4	48	51	100
2012	53-2	3 1/4	3	3 3/8	122	130	50
2013	53-3	3 3/8	3 3/8	3	128	136	50
2026	53-4	3 3/4	3	4 1/8	230	243	27
2014	53-5	4 3/8	4 1/8	4	226	238	32

FOR SELECTION AND APPLICATION INFORMATION—See Section 12.0.3.