



VACUUM CIRCUIT BREAKERS Types VIB and VIBC



ORDERING INSTRUCTIONS

1. Always specify complete nameplate data of the breaker.
2. Specify the quantity, catalog number (if listed), reference number (if listed), description, and this bulletin number.
3. Standard hardware such as screws, bolts, nuts, washers, etc., is not listed in this bulletin. Such items should be purchased locally.
4. For prices, refer to the nearest office of the General Electric Company.

When ordering renewal parts, give quantity, catalog number, description of each item required, and complete nameplate reading.

GENERAL  **ELECTRIC**

TYPES VIB AND VIBC VACUUM CIRCUIT BREAKERS

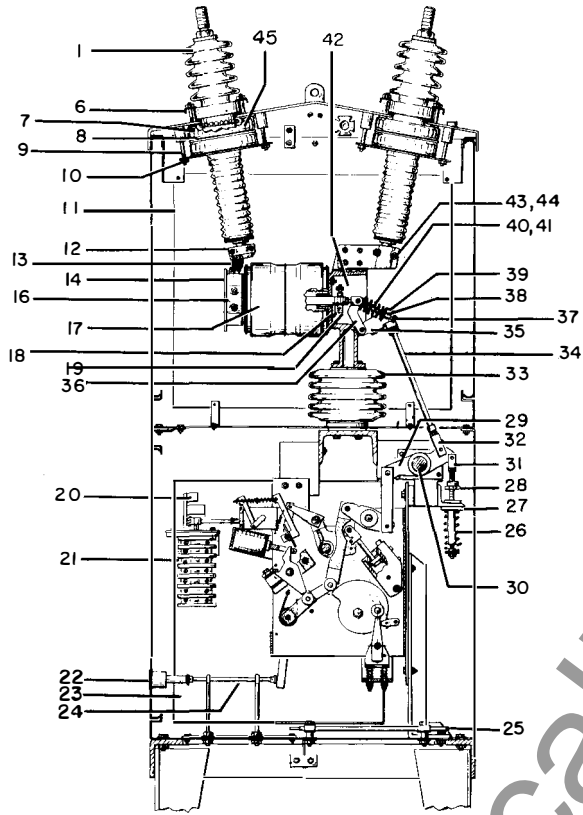

TYPE VIB

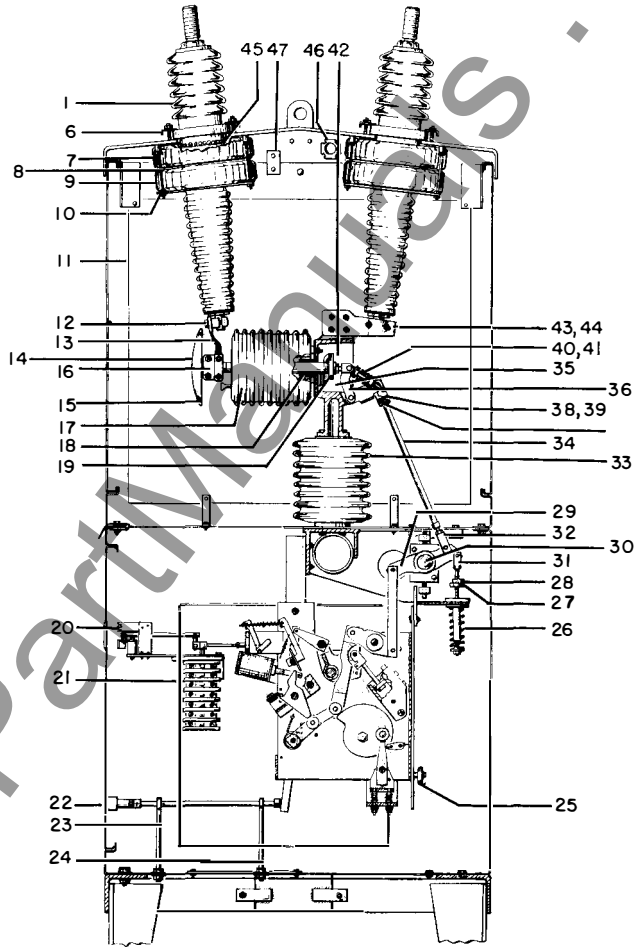

TYPE VIBC

Fig. 1

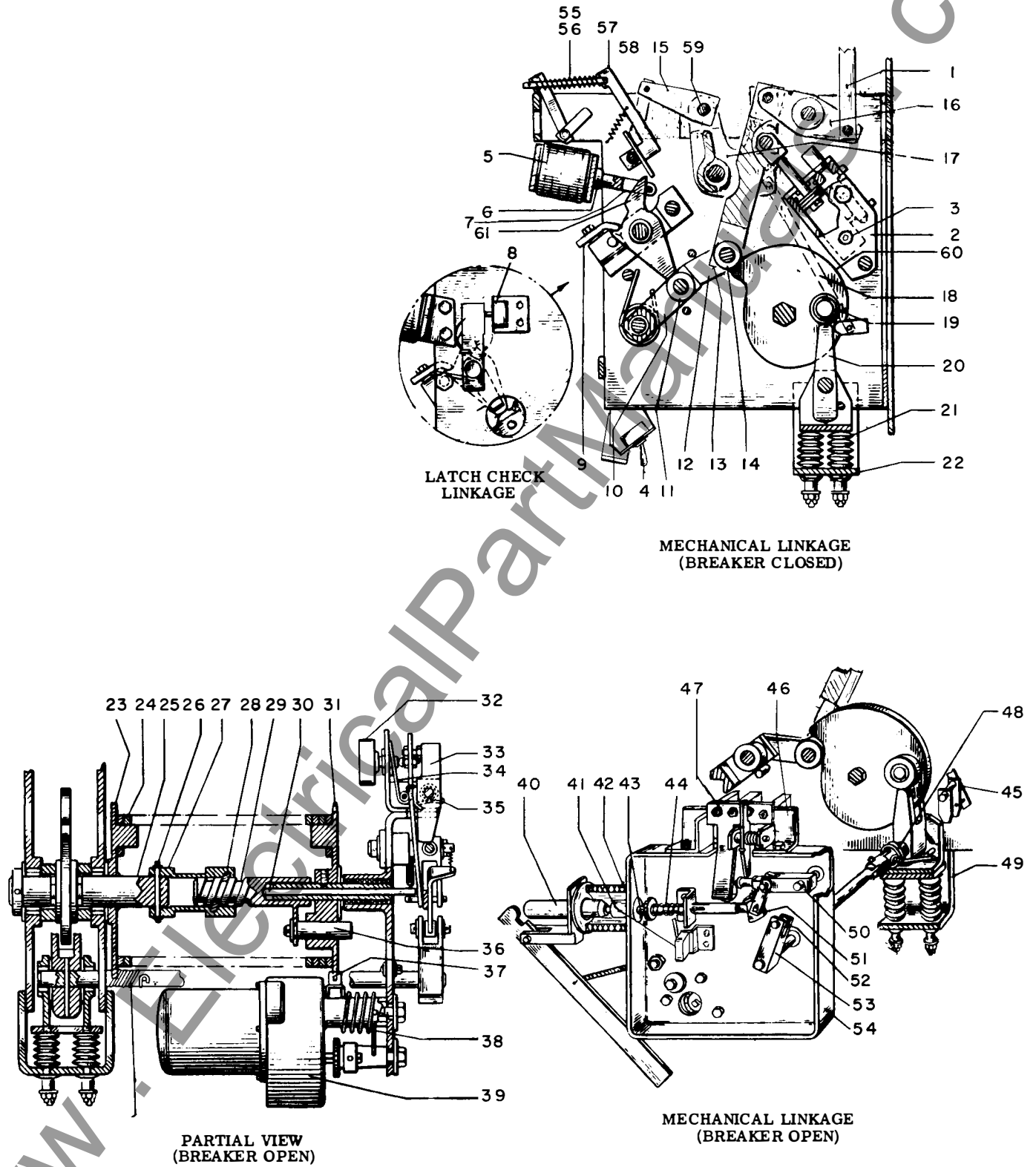

Fig. 2

TYPES VIB AND VIBC VACUUM CIRCUIT BREAKERS

GEF-4646

MECHANISM
MLV-10-0
(see Fig. 2)

Ref. No.	Catalog Number	No. Req'd	Description
1	203A3475P1	1	Output link
2	268B674G6	1	Dashpot
3	182V268P1	1	Dashpot fill plug
†4	307V199P1	1	Toggle switch (69)
5	-----	1	Trip coil (see table 2)
6	268B665G2	1	Trip coil armature
7	103A1104G1	1	Trip latch
†8	466A866P5	1	Latch checking switch
9	103A5167P	1	Trip latch stop plate
10	422A404G1	1	Trip free link with bushing
11	183V714P1	1	Trip latch roller
12	183V701P1	1	Intermediate link
13	422A404G1	1	Toggle link with bushing
14	183V714P1	1	Cam follower roller
15	124C3271P3	1	Interlock link
16	124C3273G1	1	Output crank
17	124C3274P	1	Auxiliary crank
18	286B416G5	1	Closing cam
19	382A254G1	1	Cam prop roller with bushing
20	437A829P1	1	Cam prop
21	182V563P1	40	Spring washer
22	182V559P1	16	Belleville washer
23	103A414G1	1	Spring plate
24	454A196P1	1	Spring (closing, large)
25	103A1414G1	1	Shaft
26	138A7831P1	1	Pin
27	103A1422P1	1	Coupling
28	103A1423P1	1	Key
29	428A866G1	1	Jack screw
30	182V257P1	1	Control plunger
31	275B110G1	1	Sprocket wheel
†32	132A1031P42	3	Spring cutout and motor governor switches
33	103A1468G1	1	Latch
34	428A882P1	1	Paddle spring
35	103A5191P1	1	Latch spring
36	182V255P1	1	Movable stop pin
37	103A6970G1	1	Ratchet pawl
38	421A764P1	1	Ratchet spring
†39	-----	1	Spring-charging motor (see table 2)
40	214X773G3	1	Armature, pole piece, angle and washer (dc)
40	214X773G2	1	Armature, pole piece, angle and washer (115 volt ac)
40	214X773G1	1	Armature, pole piece, angle and washer (230 volt ac)
†41	179V585P1	1	CCX switch
†42	-----	1	Closing release coil (see table 2)
43	103A1472P1	1	Closing release coil plunger
44	438A565P1	1	Return spring
45	104B3805G1	1	Prop interlock
46	103A1103G3	1	Switch bracket
47	103A1105G3	1	Paddle
48	428A991P1	1	Cam prop return spring
49	177V989P1	1	Bracket
50	186A8179P1	1	Lever
51	437A856G1	1	Closing release pawl
52	183V787P1	1	Roller
53	183V786P1	1	Cam prop lever
54	295B531G1	1	Motor support bracket with bushing
55	103A2824P1	1	Spring
56	438A565P1	1	Spring
57	103A2812G1	1	Lever assembly
58	103A3635P1	1	Spring
59	138A7675P1	1	Maintenance closing pin
60	138A7596P3	1	Link
61	295B942P4	-	Trip latch clearance shims
†62	132A1578P1	2	Fuse pullout (30A)
†63	132A1578P2	1	Fuse pullout (60A)
†64	6203764P1	4	Fuse (10A)
†65	6203764P8	2	Fuse (35A)
†66	6203764P11	2	Fuse (50A)
†67	6203764P4	2	Fuse (15A)
†68	6203764P5	2	Fuse (20A)

† Not illustrated

† Parts recommended for normal stock

TYPES VIB AND VIBC VACUUM CIRCUIT BREAKERS

GEF-4646

(See Fig. 1)

Ref. No.	Quantity Required per Breaker Type -												Catalog Number	Description	
	VIB						VIBC								
	15.5-12,000-4 600 Amp.	15.5-16,000-1 800 Amp.	15.5-16,000-1 1200 Amp.	15.5-20,000-04 12,000 Amp.	15.5-20,000-1 1200 Amp.	15.5-20,000-2 1200 Amp.	15.5-25,000-0 1200 Amp.	15.5-25,000-1 1200 Amp.	15.5-28,000-0 1200 Amp.	15.5-20,000-0 2000 Amp.	15.5-25,000-0 2000 Amp.	25.8-16,000-0 1200 Amp.			25.8-20,000-0 1200 Amp.
1	6	6	6	6	6	6	6	6	6	6	6	6	6	See table 1	Bushing assembly
6	18	18	18	18	18	18	18	18	18	24	24	24	24	104B3637P1	Bushing clamp
*7	-	-	-	-	-	-	-	-	-	-	-	-	-	-----	Bushing current transformer
*8	-	-	-	-	-	-	-	-	-	-	-	-	-	-----	Bushing current transformer insulation
*9	-	-	-	-	-	-	-	-	-	-	-	-	-	-----	Bushing current transformer stud
*10	-	-	-	-	-	-	-	-	-	-	-	-	-	-----	Bushing current transformer support plate
11	2	2	2	2	2	2	2	2	2	2	2	2	2	128C9944P6	Interphase barrier
11	-	-	-	-	-	-	-	-	-	2	2	2	2	128C9944P5	Interphase barrier
12	3	3	3	3	3	3	3	3	3	-	-	-	-	203A3486P2	Connector, rear (near side)
12	3	3	3	3	3	3	3	3	3	-	-	-	-	203A3486P3	Connector, rear (far side)
12	-	-	-	-	-	-	-	-	-	6	6	6	6	159C1053P3	Connector, rear
13	6	6	6	6	6	6	6	6	6	-	-	-	-	203A3485G1	Flexible lead
13	-	-	-	-	-	-	-	-	-	2	2	6	6	251A9020G2	Flexible lead
14	6	6	6	6	6	6	6	6	6	-	-	-	-	159C1007P1	Radiator connector
14	-	-	-	-	-	-	-	-	-	6	6	6	6	159C1053P5	Radiator connector
15	-	-	-	-	-	-	-	-	-	3	3	3	3	159C1002P1	Shield
16	6	6	6	6	6	6	6	6	6	-	-	-	-	203A3475P2	Clamp
16	-	-	-	-	-	-	-	-	-	3	3	-	-	159C1057P2	Clamp
16	-	-	-	-	-	-	-	-	-	3	3	-	-	159C1057P3	Clamp
16	-	-	-	-	-	-	-	-	-	-	-	3	3	159C1058P2	Clamp
16	-	-	-	-	-	-	-	-	-	-	-	3	3	159C1058P3	Clamp
¶17	3	3	-	-	-	-	-	-	-	-	-	-	-	197B4900P1	Interrupter
¶17	-	-	3	3	3	3	-	-	-	-	-	-	-	197B4900P7	Interrupter
¶17	-	-	-	-	-	-	3	-	3	3	-	-	-	197B4900P5	Interrupter
¶17	-	-	-	-	-	-	-	3	-	-	3	-	-	197B4900P6	Interrupter
¶17	-	-	-	-	-	-	-	-	-	-	-	3	3	197B4900P8	Interrupter
18	3	3	3	3	3	3	-	-	-	-	-	-	-	128C9930P8	Clevis
18	-	-	-	-	-	-	3	3	3	-	-	3	3	128C9930P1	Clevis
19	3	3	-	-	-	-	-	-	-	-	-	-	-	193A2831G1	Flexible connector and block
19	-	-	3	3	3	3	-	-	-	-	-	-	-	191B4433G1	Flexible connector and block
19	-	-	-	-	-	-	3	3	3	-	-	3	3	191B4433G2	Flexible connector and block
20	1	1	1	1	1	1	1	1	1	1	1	1	1	103A3075P2	Counter
21	1	1	1	1	1	1	1	1	1	1	1	1	1	183B8406G1	Auxiliary switch (11 stage)
*22	1	1	1	1	1	1	1	1	1	1	1	1	1	-----	Manual trip button
23	2	2	2	2	2	2	2	2	2	2	2	2	2	181B9206P2	Manual trip extension guide
24	1	1	1	1	1	1	1	1	1	-	-	-	-	181B9206P1	Manual trip extension rod
24	-	-	-	-	-	-	-	-	-	1	1	1	1	181B9206P7	Manual trip extension rod
¶25	1	1	1	1	1	1	1	1	1	1	1	1	1	132A1384P1	Heater (115 volt, ac)
¶25	1	1	1	1	1	1	1	1	1	1	1	1	1	132A1384P2	Heater (230 volt, ac)
26	3	3	3	3	3	3	3	3	3	-	-	-	-	202A7434P1	Bias spring
26	-	-	-	-	-	-	-	-	-	3	3	3	3	254A1263P1	Bias spring
27	3	3	3	3	3	3	3	3	3	-	-	-	-	128C9964G1	Spring guide
27	-	-	-	-	-	-	-	-	-	3	3	3	3	128C9964G1	Spring guide
28	2	2	2	2	2	2	2	2	2	2	2	2	2	254A1272P1	Locknut
29	3	3	3	3	3	3	-	-	-	3	-	-	-	193B9411P2	Main crank
29	-	-	-	-	-	-	3	3	3	-	-	-	-	193B9411P1	Main crank
30	1	1	1	1	1	1	1	1	1	-	-	-	-	128C9939P1	Shaft
30	-	-	-	-	-	-	-	-	-	1	1	1	1	193B8942G1	Shaft
31	3	3	3	3	3	3	3	3	3	3	3	3	3	128C9930P5	Bias spring coupling
32	3	3	3	3	3	3	3	3	3	-	-	-	-	128C9930P14	Operating rod adjustable coupling
32	-	-	-	-	-	-	-	-	-	3	3	3	3	251A9040P1	Operating rod adjustable coupling
33	3	3	3	3	3	3	3	3	3	-	-	-	-	104B3599G2	Stand-off insulator
33	-	-	-	-	-	-	-	-	-	3	3	3	3	161A4123G1	Stand-off insulator
34	3	3	3	3	3	3	3	3	3	-	-	-	-	123C9944G1	Insulated operating rod
34	-	-	-	-	-	-	-	-	-	3	3	-	-	123C9944G3	Insulated operating rod
34	-	-	-	-	-	-	-	-	-	-	-	3	3	123C9944G4	Insulated operating rod
35	3	3	3	3	3	3	3	3	3	-	-	-	-	128C9927P4	Saddle link
35	-	-	-	-	-	-	-	-	-	3	3	-	-	203A3413P1	Saddle link
36	6	6	6	6	6	6	6	6	6	6	6	6	6	128C9927P7	Contact guide link
37	3	3	3	3	3	3	3	3	3	3	3	3	3	128C9927P5	Wipe spring guide
38	3	3	3	3	3	3	3	3	3	3	3	3	3	6477429P2	Wipe spring stop nut
39	3	3	3	3	3	3	3	3	3	3	3	3	3	128C9930P2	Trunnion pin
40	3	3	3	3	3	3	3	3	3	3	3	3	3	202A8398P1	Wipe spring, inner
41	3	3	3	3	3	3	3	3	3	-	-	-	-	202A8	Wipe spring, outer
42	3	3	3	-	-	-	3	-	-	-	-	-	-	197B4909G2	Interrupter support
42	-	-	-	3	3	-	-	3	-	-	-	3	3	125D6909P1	Interrupter support
42	-	-	-	-	-	-	-	-	-	-	-	-	-	197B4909G1	Interrupter support
42	-	-	-	-	-	-	-	-	-	3	-	-	-	104D6118G1	Interrupter support
42	-	-	-	-	-	-	-	-	-	-	-	-	-	695D798G1	Interrupter support
43	3	3	3	3	3	3	3	3	3	-	-	-	-	193B8962P1	Clamp, front (near side)
43	-	-	-	-	-	-	-	-	-	3	3	-	-	156C1057P2	Clamp, front (near side)
43	-	-	-	-	-	-	-	-	-	-	-	3	3	159C1058P2	Clamp, front (near side)
44	3	3	3	3	3	3	3	3	3	-	-	-	-	193B8962P2	Clamp, front (far side)
44	-	-	-	-	-	-	-	-	-	3	3	-	-	159C1057P3	Clamp, front (far side)
44	-	-	-	-	-	-	-	-	-	-	-	3	3	159C1058P3	Clamp, front (far side)
45	1	1	1	1	1	1	1	1	1	1	1	1	1	158A8808G2	Spring assembly
*46	-	-	-	-	-	-	-	-	-	-	-	-	-	-----	Breather
*47	-	-	-	-	-	-	-	-	-	-	-	-	-	-----	Ground jumper

* When ordering, refer to factory listing serial number of breaker and quantity required.

¶Parts recommended for normal stock

TYPES VIB AND VIBC VACUUM CIRCUIT BREAKERS

TABLE 1

Ref. No.	Quantity Required per Breaker Type -												Catalog Number	Description	
	VIB						VIBC								
	15.5-12,000-4 600 Amp.	15.5-16,000-1 800 Amp.	15.5-16,000-1 1200 Amp.	15.5-20,000-04 12,000 Amp.	15.5-20,000-1 1200 Amp.	15.5-20,000-2 1200 Amp.	15.5-25,000-0 1200 Amp.	15.5-25,000-1 1200 Amp.	15.5-28,000-0 1200 Amp.	15.5-20,000-0 2000 Amp.	15.5-25,000-0 2000 Amp.	25.8-16,000-0 1200 Amp.			25.8-20,000-0 1200 Amp.
1	6	6	-	-	-	-	-	-	-	-	-	-	-	104B3735G13	Bushing (grey), threaded stud
1	-	-	6	6	6	6	-	6	-	-	-	-	-	128C9937G3	Bushing (brown), threaded stud
1	-	-	-	-	-	-	-	-	-	-	-	-	-	128C9937G9	Bushing (brown), threaded stud
1	-	-	6	6	6	6	-	6	6	-	-	-	-	128C9937G1	Bushing (grey), threaded stud
1	-	-	-	-	-	-	-	-	6	6	-	-	-	104D6119G5	Bushing (brown), threaded stud
1	-	-	-	-	-	-	-	-	-	6	6	-	-	104D6119G1	Bushing (grey), threaded stud
1	-	-	-	-	-	-	-	-	-	-	6	6	-	104D6119G6	Bushing (brown), threaded stud
1	-	-	-	-	-	-	-	-	-	-	6	6	-	104D6119G3	Bushing (grey), threaded stud
††2	6	6	-	-	-	-	-	-	-	-	-	-	-	138A7888P2	Upper gasket
††2	-	-	6	6	6	6	6	6	6	-	-	-	-	202A7427P2	Upper gasket
††2	-	-	-	-	-	-	-	-	6	6	-	-	-	202A7427P8	Upper gasket
††2	-	-	-	-	-	-	-	-	-	-	6	6	-	202A7427P6	Upper gasket
††3	6	6	6	6	6	6	6	6	6	-	-	-	-	104B3729P2	Porcelain (grey)
††3	-	-	6	6	6	6	6	6	6	-	-	-	-	104B3729P1	Porcelain (brown)
††3	-	-	-	-	-	-	-	-	6	6	-	-	-	159C1040P2	Porcelain (brown)
††3	-	-	-	-	-	-	-	-	6	6	-	-	-	159C1040P1	Porcelain (grey)
††3	-	-	-	-	-	-	-	-	-	-	6	6	-	159C1041P4	Porcelain (brown)
††3	-	-	-	-	-	-	-	-	-	-	6	6	-	159C1041P3	Porcelain (grey)
††4	6	6	-	-	-	-	-	-	-	-	-	-	-	138A7888P1	Lower gasket
††4	-	-	6	6	6	6	6	6	6	-	-	-	-	202A7427P1	Lower gasket
††4	-	-	-	-	-	-	-	-	6	6	-	-	-	202A7427P7	Lower gasket
††4	-	-	-	-	-	-	-	-	-	-	6	6	-	202A7427P6	Lower gasket
† 5	6	6	-	-	-	-	-	-	-	-	-	-	-	138A7132P1	Belleville washer
† 5	-	-	6	6	6	6	6	6	6	-	-	-	-	202A7438P1	Belleville washer
† 5	-	-	-	-	-	-	-	-	6	6	-	-	-	251A9078P2	Belleville washer
† 5	-	-	-	-	-	-	-	-	-	-	6	6	-	251A9078P1	Belleville washer

TABLE 2

Voltage Rating	Potential Trip Coil Ref. No. 5	Closing Release Coil Ref. No. 42	†Seal-in Resistor (Not Illustrated)	Motor Ref. No. 39
24 d-c	6174582G27	-----	-----	-----
48 d-c	6174582G32	6174582G39	235L434G11	268B673P3
125 d-c	6174582G22	6174582G22	235L434G15	268B673P2
250 d-c	6174582G2	6174582G2	235L434G10	268B673P1
115 a-c	6174582G27	366A764G1	103A5114P2	268B673P2
230 a-c	6174582G32	6174582G10	103A5114P1	268B673P1

†Parts recommended for normal stock

† Not illustrated

GENERAL ELECTRIC COMPANY
SWITCHGEAR BUSINESS DEPARTMENT
PHILADELPHIA, PA 19142

